

**Housing Authority of the
County of Stanislaus**

(209) 557-2069
1701 Robertson Road
P. O. Box
581918

March 1, 2010

Addendum to Bid # 10894

Schedule of units to have cabinets manufactured.

Model A is 4 – 2 Bedroom Duplex Apartments (Total of 8units)

Model B is 3 – 2 Bedroom Duplex Apartments (Total of 6 units)

Model C is 6 - 4 Bedroom Duplex Apartments (Total of 12 units)

Model D is 14 – 3 Bedroom Duplex Apartments (Total of 28 units)

The total of Apartments is 54 Units

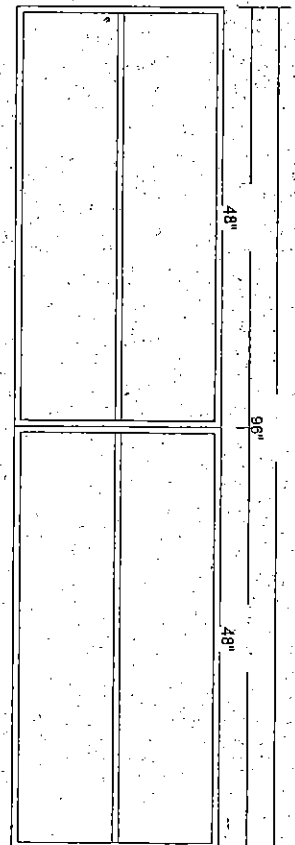
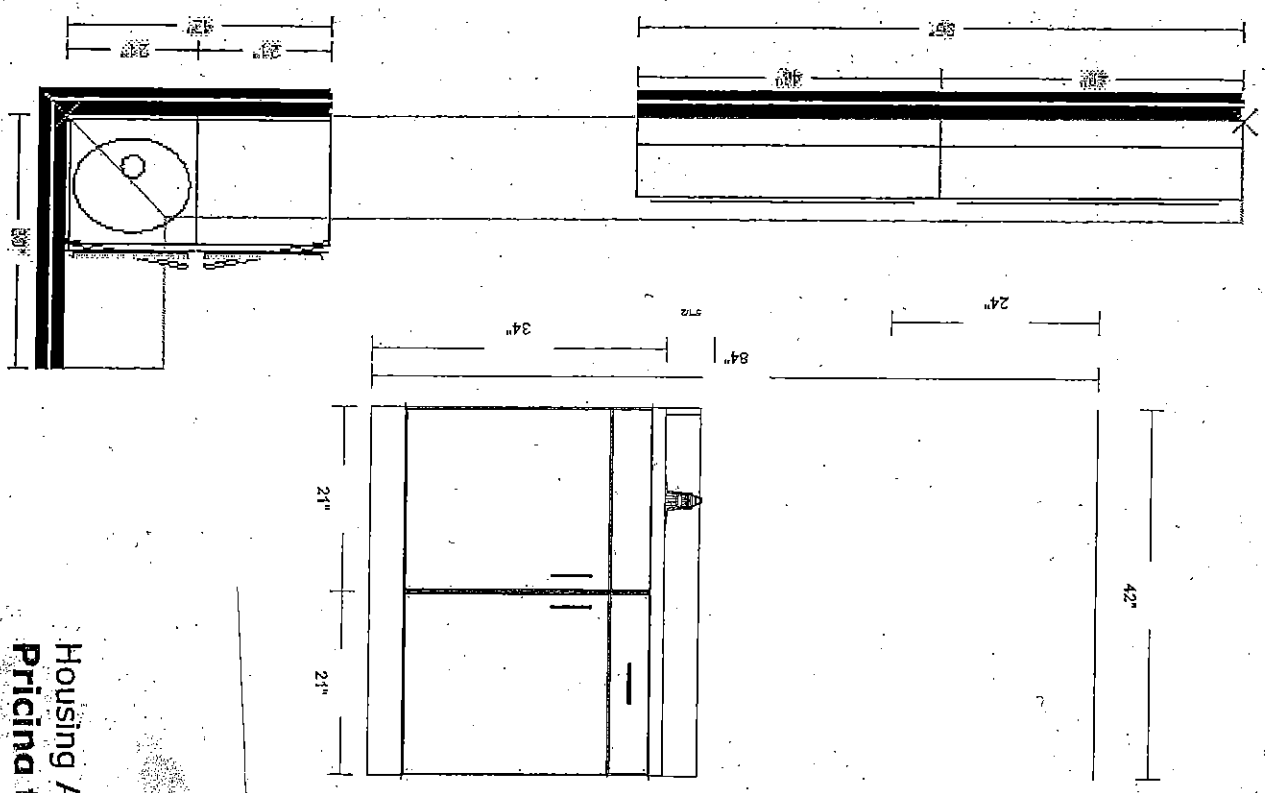

Housing Authority for County of Stanislaus
Pricing for Ceres Housing Upgrades - Building Type "A"

4 @ BUILDING TYPE "A"
2-BEDROOM DUPLEX APARTMENTS (8 Total Apartments)

CABINET TYPE	NUMBER OF CABINETS
Euro Kitchen (17.5 feet)	5 Base, 7 Upper
Euro Vanity BV42	2 Base
Euro Laundry W9624	2 Upper

ALL APPLIANCES AND COUNTERTOPS SHOWN FOR ILLUSTRATION PURPOSES ONLY.

Cabinets	STEEL
Cab box material	TBD
Cab box color	THERMOFOIL
Door material	TBD
Door color	TBD
Door style	TBD
Countertop/Sink/Faucet	N.I.C.
Countertop material	N.I.C.
Color name/number	-
Sink type	-
Sink dimension	-
Faucet type	N.I.C.
Faucet finish	-
Appliances	N.I.C.
Refrig type/color	N.I.C.
Range type/size	N/A
Range color	N/A
Cooktop	N/A
Dishwasher size/color	N/A
Microwave type	N/A
Microwave size	N/A
Microwave color	N/A

- Notes**
1. For recessed units additional refrigerator space is needed. For door to open properly, allow 25-1/2" space total.
 2. Kitchen cabinetry and appliances must be installed at finished floor height (for removability).
 3. Refer to sheet 2 for roughing-in detail.
 4. Specifications subject to change.
 5. Linear dimensions are shown in inches and [millimeters].
 6. Drawing is not drawn to scale.

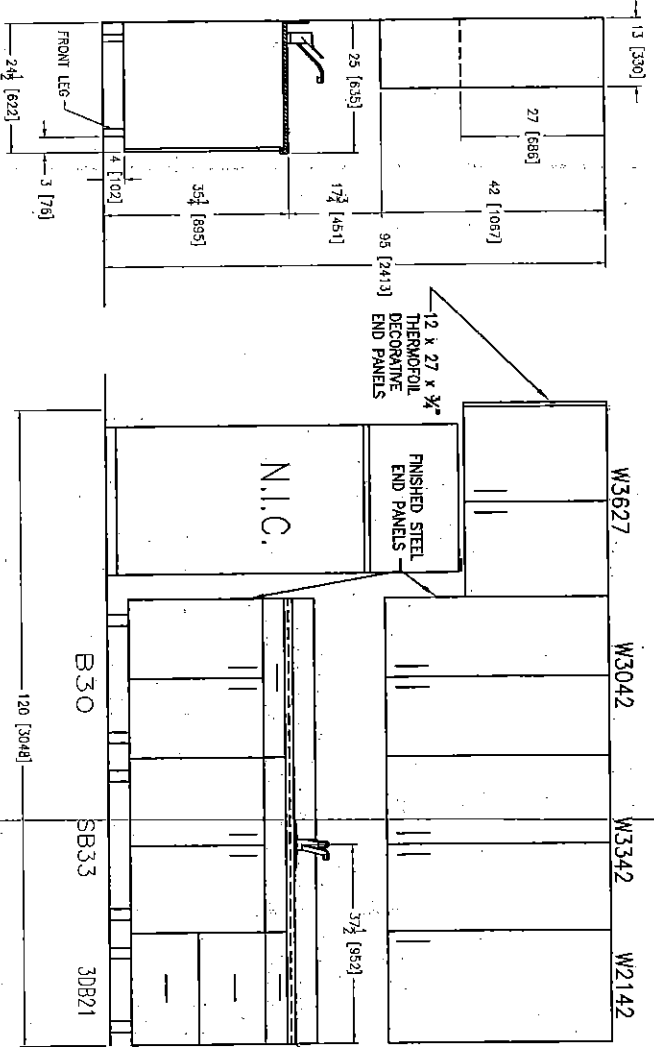

APPROVED SIGNATURE: _____

LAYOUT ORIENTATION

FREE STANDING
 FULL RECESSED
 LEFT RECESSED
 RIGHT RECESSED

DRAWN: PH DATE: 10/01/09 REP.: 249

Accessories:

KC-22647-B1

No. of Units: 1

Backwall Shield MATERIAL/Color: N/A

CUSTOM KITCHEN DESIGNED FOR:

REVISED:

Endwall Shield material/Color: N/A

CERES FARM LABOR 2 BEDROOM UNIT

REVISED:

Under Cabinet Light: N/A

MODEL: A-Slants

Range Hood Size/Color: -

ALL APPLIANCES AND COUNTERTOP SHOWN FOR ILLUSTRATION PURPOSES ONLY.

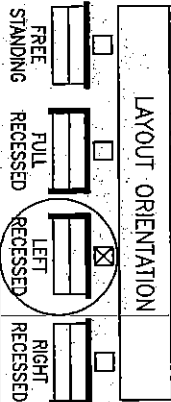
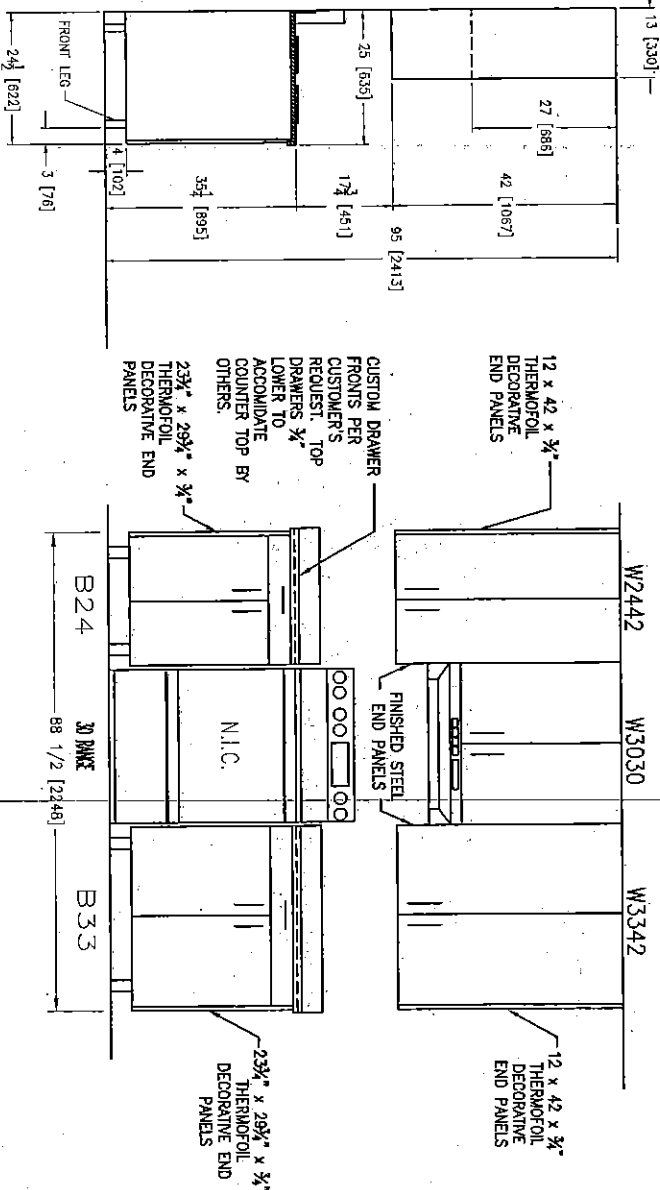

APPROVED SIGNATURE: _____

DRAWN: PH DATE: 10/01/09 REP.: 249

No. of Units: 1
 REVISED:
 REVISED:

Accessories:

Backwall: Shield MATERIAL/Color: N/A
 Endwall: Shield material/Color: N/A
 Disposal: N/A
 Under Cabinet Light: N/A
 Range Hood Size/Color: N/A

KC-22647-B2

CUSTOM KITCHEN
 DESIGNED FOR:
 CERES FARM LABOR
 2 BEDROOM UNIT

MODEL: *A-81212*

Cabinets	
Cab box material	STEEL
Cab box color	TBD
Door material	THERMOFOIL
Door color	TBD
Door style	TBD
Countertop material	N.I.C.
Color name/number	-
Sink type	-
Sink dimension	-
Faucet type	-
Faucet finish	-
Appliances	
Refrig type/color	N.I.C.
Range type/size	N.I.C.
Range color	N/A
Cooktop	N/A
Dishwasher size/color	N/A
Microwave type	N/A
Microwave size	N/A
Microwave color	N/A

Notes

1. For recessed units additional refrigerator space is needed. For door to open properly, allow 25-1/2" space total.
2. Kitchen cabinetry and appliances must be installed at finished floor height (for removability).
3. Refer to sheet 2 for roughing-in detail.
4. Specifications subject to change.
5. Linear dimensions are shown in inches and [millimeters].
6. Drawing is not drawn to scale.

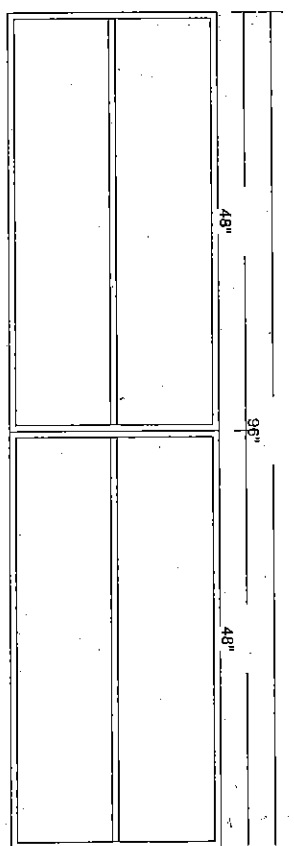
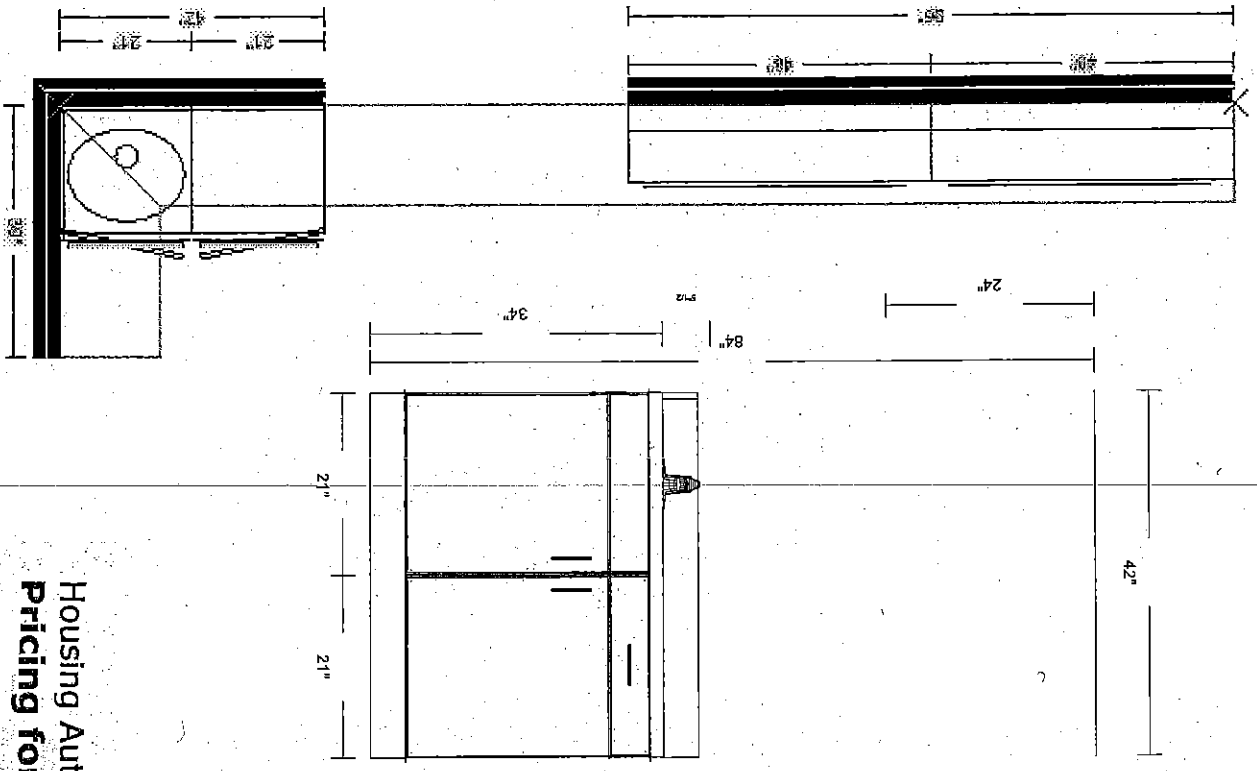

Housing Authority for County of Stanislaus
Pricing for Ceres Housing Upgrades – Building Type “B”

3 @ BUILDING TYPE “B”
2-BEDROOM DUPLEX APARTMENTS (6 Total Apartments)

CABINET TYPE	NUMBER OF CABINETS
Euro Kitchen (20.5 feet)	5 Base, 7 Upper
Euro Vanity BV42	2 Base
Euro Laundry W9624	2 Upper

ALL APPLIANCES AND COUNTERTOPS SHOWN FOR ILLUSTRATION PURPOSES ONLY.

Cabinets	STEEL
Cab box material	TBD
Cab box color	THERMOFOIL
Door material	TBD
Door color	TBD
Door style	TBD
Countertop/Sink/Faucet	N.I.C.
Countertop material	N.I.C.
Color name/number	-
Sink type	-
Sink dimension	-
Faucet type	N.I.C.
Faucet finish	-
Appliances	N.I.C.
Refrig type/color	N.I.C.
Range type/size	N/A
Range color	N/A
Cooktop	N/A
Dishwasher size/color	N/A
Microwave type	N/A
Microwave size	N/A
Microwave color	N/A

Notes

1. For recessed units additional refrigerator space is needed. For door to open properly, allow 25-1/2" space total.
2. Kitchen cabinetry and appliances must be installed at finished floor height (for removability).
3. Refer to sheet 2 for roughing-in detail.
4. Specifications subject to change.
5. Linear dimensions are shown in inches and [millimeters].
6. Drawing is not drawn to scale.

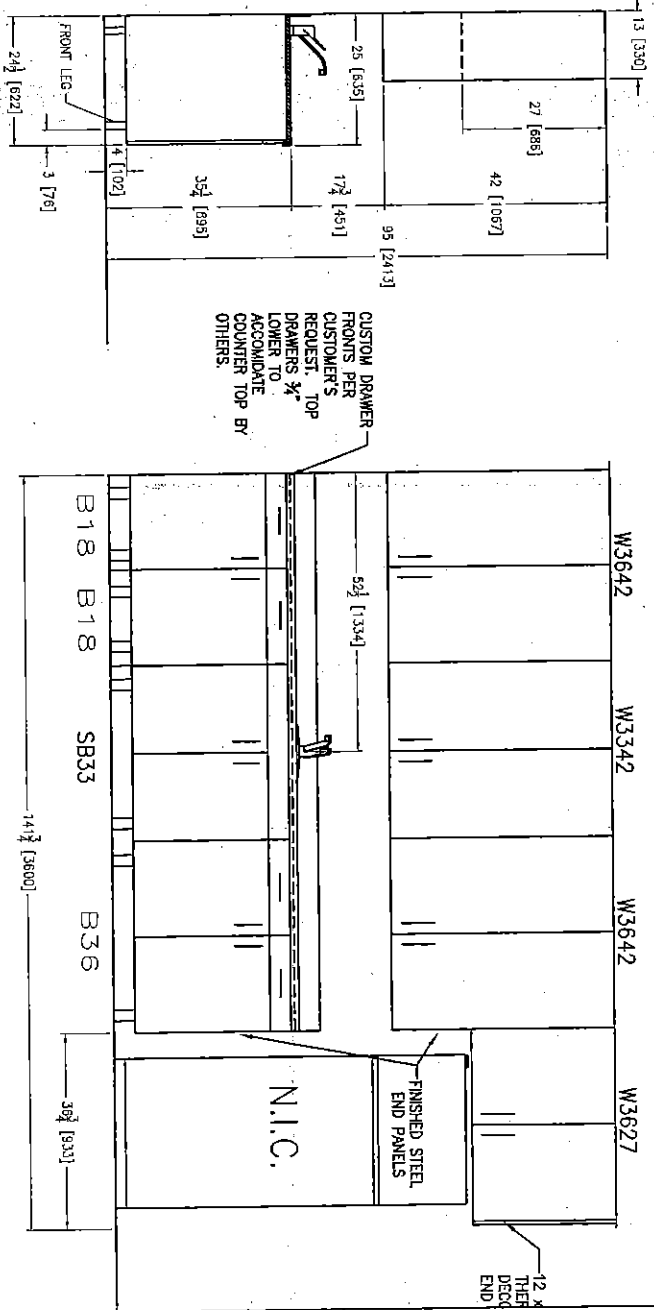

APPROVED SIGNATURE: _____

DRAWN: PH DATE: 10/01/09 REP.: 249

No. of Units: 8

REVISED: OVERALL DIMENSIONS REISED/ CABINETS ADDED 09/25/09

REVISED:

Accessories:

Backwall Shield Material/Color	N/A
Endwall Shield material/Color	N/A
Disposal:	N/A
Under Cabinet Light:	N/A
Range Hood Size/Color	-

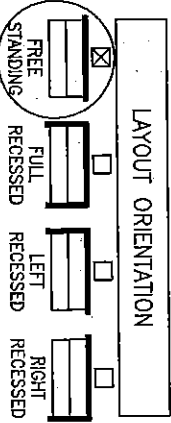

ELEVATION

KC-22647-A1

CUSTOM KITCHEN DESIGNED FOR:

CERES FARM LABOR 2 BEDROOM UNIT

MODEL

B. White

Cabinets

Cab box material	STEEL
Cab box color	TBD
Door material	THERMOFOIL
Door color	TBD
Door style	TBD
Countertop/Sink/Faucet	N.I.C.
Color name/number	-
Sink type	-
Sink dimension	-
Faucet type	-
Faucet finish	-
Appliances	N.I.C.
Refrig type/color	N.I.C.
Range type/size	N/A
Range color	N/A
Cooktop	N/A
Dishwasher size/color	N/A
Microwave type	N/A
Microwave size	N/A
Microwave color	N/A

Notes

1. For recessed units additional refrigerator space is needed. For door to open properly, allow 25-1/2" space total.
2. Kitchen cabinetry and appliances must be installed at finished floor height (for removability).
3. Refer to sheet 2 for roughing-in detail.
4. Specifications subject to change.
5. Linear dimensions are shown in inches and [millimeters].
6. Drawing is not drawn to scale.

ALL APPLIANCES AND COUNTERTOP SHOWN FOR ILLUSTRATION PURPOSES ONLY.

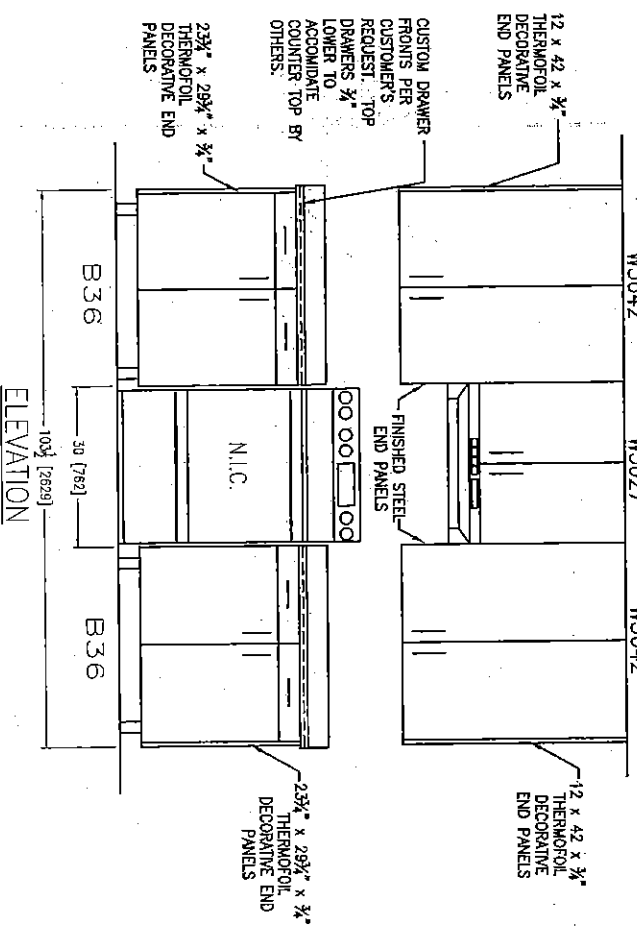
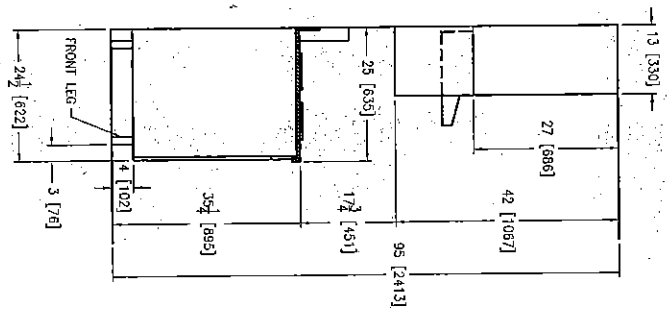

APPROVED SIGNATURE: _____

X

DRAWN: PH DATE: 10/01/09 REP.: 249

No. of Units: 8

REVISED: OVERALL DIMENSIONS REVERSED/ CABINETS SIZES REVERSED 09/26/09

REVISED:

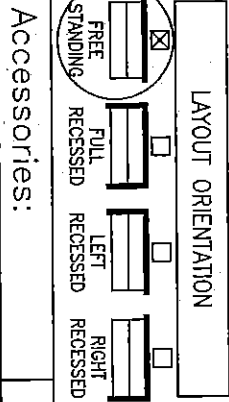

Accessories:

Backwall Shield MATERIAL/Color: N/A

Endwall Shield material/Color: N/A

Disposal: N/A

Under Cabinet Light: N/A

Range Hood Size/Color: N/A

©COPYRIGHT

KC-22647-A2

CUSTOM KITCHEN DESIGNED FOR:

CERES FARM, LABOR 2 BEDROOM UNIT

MODEL: B *Colvito*

Cabinets	
Cab box material	STEEL
Cab box color	TBD
Door material	THERMOFOIL
Door color	TBD
Door style	TBD
Countertop/Sink/Faucet	
Countertop material	N.I.C.
Color name/number	-
Sink type	-
Sink dimension	-
Faucet type	-
Faucet finish	-
Appliances	
Refrig type/color	-
Range type/size	N.I.C.
Range color	-
Cooktop	N/A
Dishwasher size/color	N/A
Microwave type	N/A
Microwave size	N/A
Microwave color	N/A

Notes

1. For recessed units additional refrigerator space is needed. For door to open properly, allow 25-1/2" space total.
2. Kitchen cabinetry and appliances must be installed at finished floor height (for removability).
3. Refer to sheet 2 for roughing-in detail.
4. Specifications subject to change.
5. Linear dimensions are shown in inches and [millimeters].
6. Drawing is not drawn to scale.

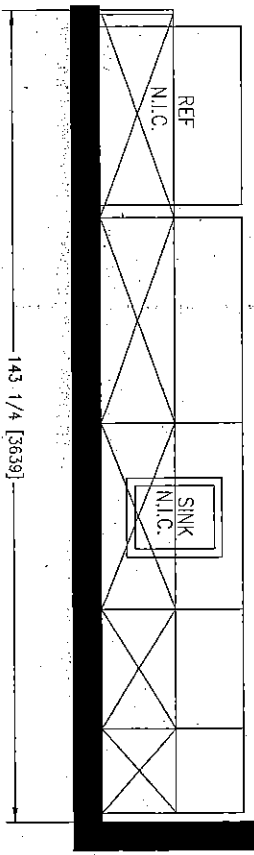
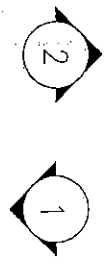
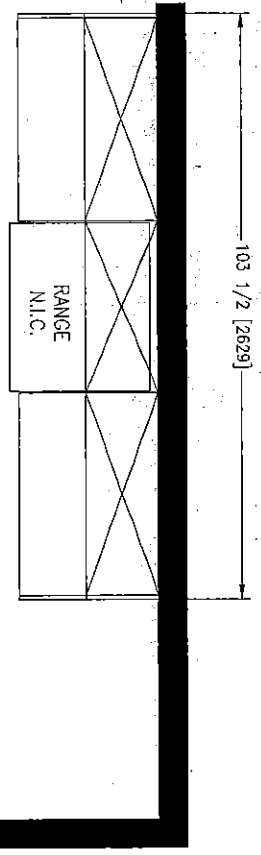

PLAN VIEW

APPROVED SIGNATURE:

X

DRAWN: PH DATE: 10/01/09 REP.: 249

No. of Units: 8
 REVISED:
 REVISED:

Accessories:

Backwall Shield Material/Color	N/A
Endwall Shield material/Color	N/A
Disposal:	N/A
Under Cabinet Light:	N/A
Range Hood Size/Color	30"

KC-22647-A

**CUSTOM KITCHEN
 DESIGNED FOR:**

CERES FARM WORKERS
 2 BEDROOM UNIT

MODEL:

B-166666

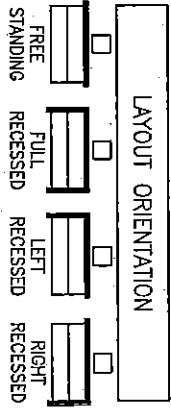

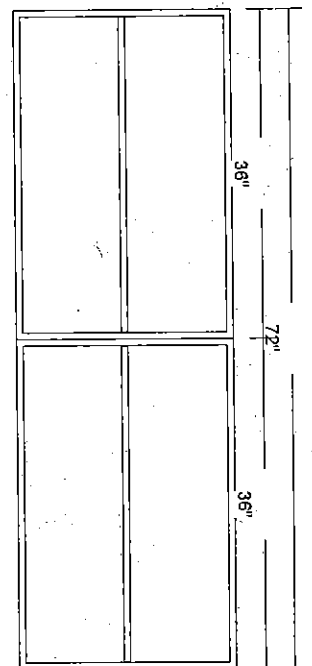
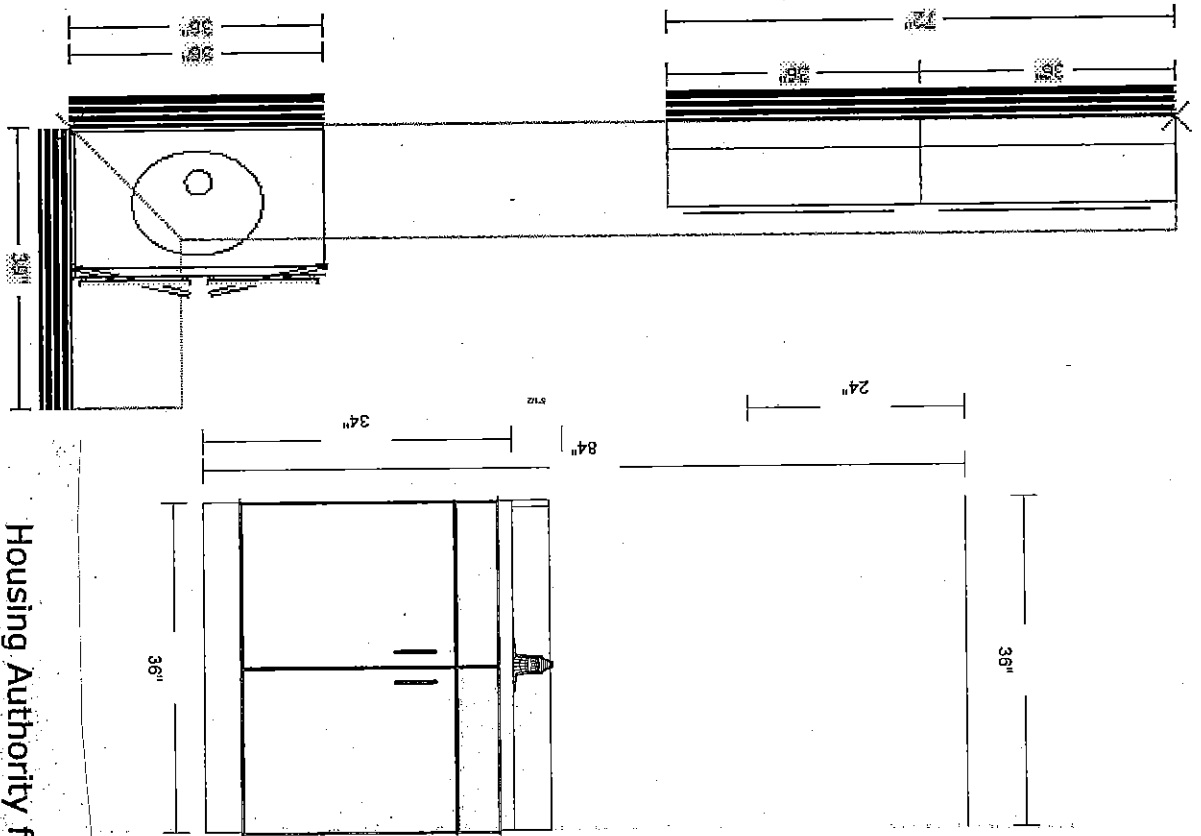

Housing Authority for County of Stanislaus
Pricing for Ceres Housing Upgrades - Building Type "C"

6 @ BUILDING TYPE "C"
4-BEDROOM DUPLEX APARTMENTS (12 Total Apartments)

CABINET TYPE	NUMBER OF CABINETS
Euro Kitchen (24 feet)	7 Base, 8 Upper
Euro Vanity 2 @ BV36	2 Base
Euro Laundry W7224	2 Upper

ALL APPLIANCES AND COUNTERTOP SHOWN FOR ILLUSTRATION PURPOSES ONLY.

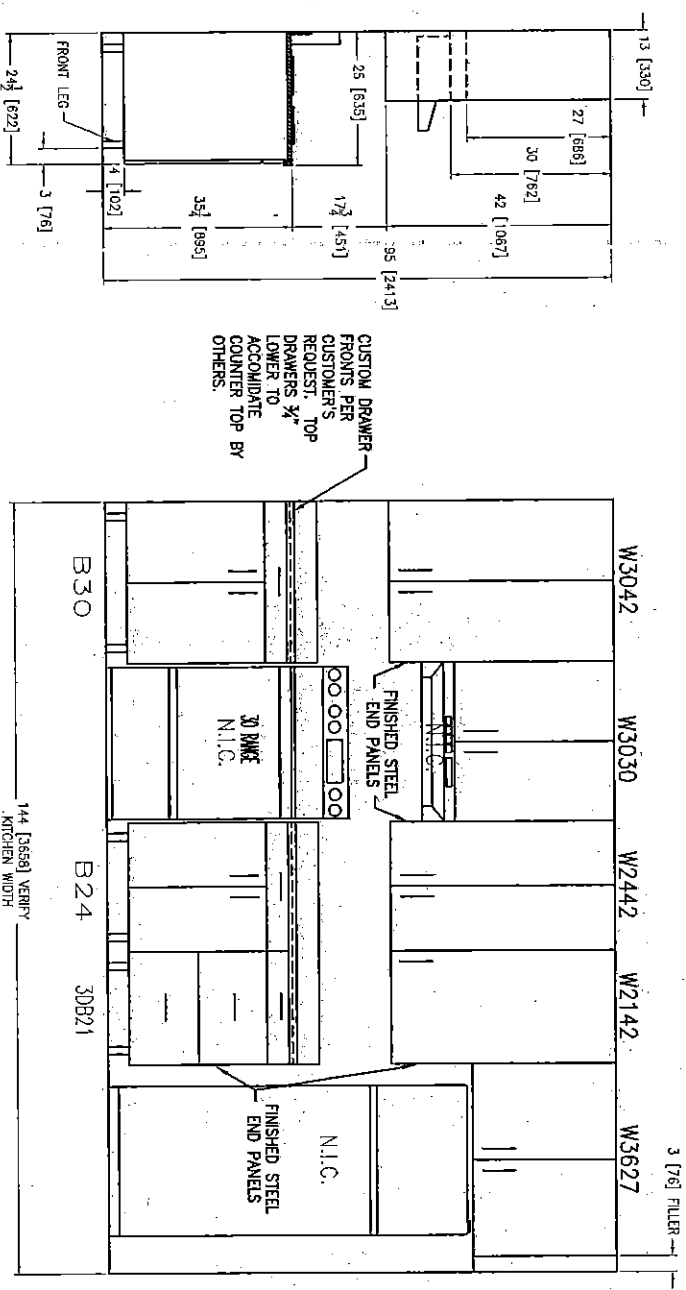

APPROVED SIGNATURE: _____

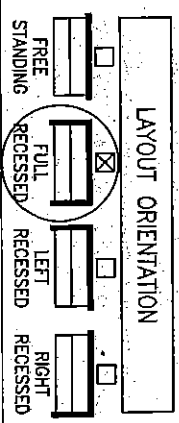

DRAWN: PH DATE: 10/01/09 REP.: 249

No. of Units: 1
 REVISED:
 REVISED:

Accessories:

Backwall Shield Material/Color: N/A
 Endwall Shield material/Color: N/A
 Disposal: N/A
 Under Cabinet Light: N/A
 Range Hood Size/Color: N/A

KC-22645-C1

CUSTOM KITCHEN DESIGNED FOR:
 CERES FARM LABOR 4 BEDROOM UNIT

MODEL: *C 12 units*

Cabinets	
Cab box material	STEEL
Cab box color	TBD
Door material	THERMOFOIL
Door color	TBD
Door style	TBD
Countertop/Sink/Faucet	
Countertop material	N.I.C.
Color name/number	-
Sink type	-
Sink dimension	-
Faucet type	-
Faucet finish	-
Appliances	
Refrig type/color	N.I.C.
Range type/size	N.I.C.
Range color	N/A
Cooktop	N/A
Dishwasher size/color	N/A
Microwave type	N/A
Microwave size	N/A
Microwave color	N/A
Notes	
1. For recessed units additional refrigerator space is needed. For door to open properly, allow 25-1/2" space total. 2. Kitchen cabinetry and appliances must be installed at finished floor height (for removability). 3. Refer to sheet 2 for roughing-in detail. 4. Specifications subject to change. 5. Linear dimensions are shown in inches and [millimeters]. 6. Drawing is not drawn to scale.	

Cabinets

Cab box material STEEL

Cab box color TBD

Door material THERMOFOIL

Door color TBD

Door style TBD

Countertop/Sink/Faucet

Countertop material N.I.C.

Color name/number -

Sink type -

Sink dimension -

Faucet type N.I.C.

Faucet finish -

Appliances

Refrig type/color N/A

Range type/size N/A

Range color N/A

Cooktop N/A

Dishwasher size/color N/A

Microwave type N/A

Microwave size N/A

Microwave color N/A

Notes

1. For recessed units additional refrigerator space is needed. For door to open properly, allow 25-1/2" space total.
2. Kitchen cabinetry and appliances must be installed at finished floor height (for removability).
3. Refer to sheet 2 for roughing-in detail.
4. Specifications subject to change.
5. Linear dimensions are shown in inches and [millimeters].
6. Drawing is not drawn to scale.

FAUCET AND COUNTERTOP SHOWN FOR ILLUSTRATION PURPOSES ONLY.

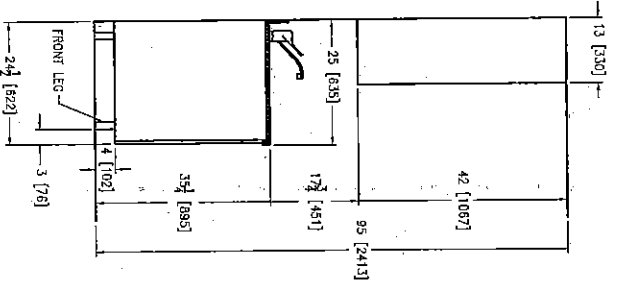

CUSTOM DRAWER FRONTS PER CUSTOMER'S REQUEST. TOP DRAWERS * LOWER TO ACCOMMODATE COUNTERTOP BY OTHERS.

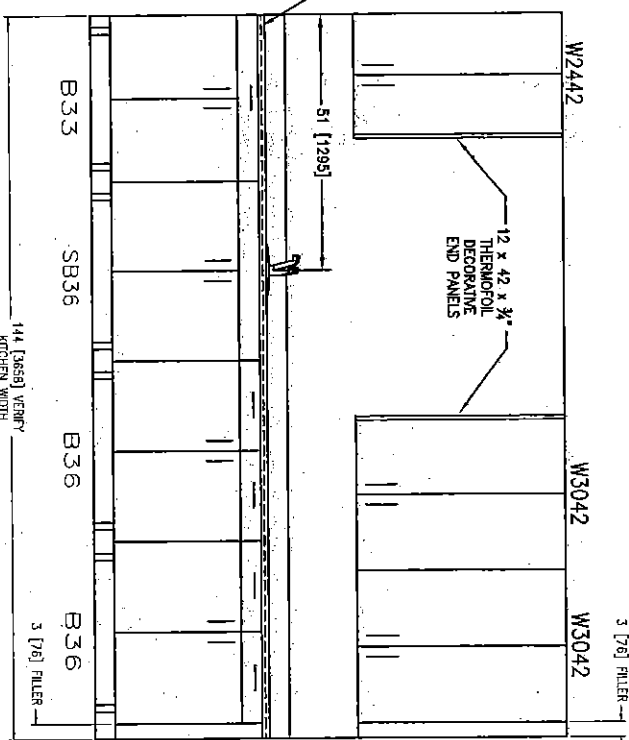

FAUCET SHOWN FOR ILLUSTRATION PURPOSES ONLY.

APPROVED SIGNATURE: X

DRAWN: PH DATE: 10/01/09 REP.: 249

No. of Units: 1

REVISED:

REVISED:

REVISED:

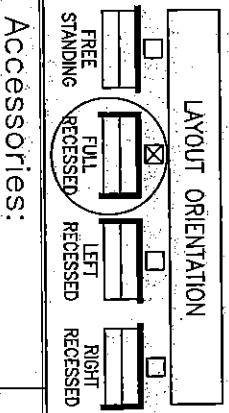

Accessories:

Backwall Shield MATERIAL/Color N/A

Endwall Shield material/Color N/A

Disposal: N/A

Under Cabinet Light: N/A

Range Hood Size/Color N/A

CUSTOM KITCHEN DESIGNED FOR:

CERES FARM LABOR 4 BEDROOM

MODEL KC-22645-C2

Q Units

Cabinets	
Cab box material	STEEL
Cab box color	TBD
Door material	THERMOFOIL
Door color	TBD
Door style	TBD
Countertop/Sink/Faucet	
Countertop material	N.I.C.
Color name/number	N/A
Sink type	N.I.C.
Sink dimension	-
Faucet type	N.I.C.
Faucet finish	-
Appliances	
Refrig type/color	N.I.C.
Range type/size	-
Range color	N.I.C.
Cooktop	N/A
Dishwasher size/color	N/A
Microwave type	N/A
Microwave size	N/A
Microwave color	N/A

- Notes**
1. For recessed units additional refrigerator space is needed. For door to open properly, allow 25-1/2" space total.
 2. Kitchen cabinetry and appliances must be installed at finished floor height (for removability).
 3. Refer to sheet 2 for roughing-in detail.
 4. Specifications subject to change.
 5. Linear dimensions are shown in inches and [millimeters].
 6. Drawing is not drawn to scale.

<p>APPROVED SIGNATURE:</p> <p>X _____</p>		<p>PLAN VIEW</p> <p>144 [3658] VERIFY</p>	
<p>DRAWN: PH</p> <p>DATE: 10/01/06</p> <p>REP.: 249</p>	<p>Accessories:</p> <p>Backwall Shield Material/Color: N/A</p> <p>Endwall Shield material/Color: N/A</p> <p>Disposed: N/A</p> <p>Under Cabinet Light: N/A</p> <p>Range Hood Size/Color: N/A</p>		
<p>No. of Units: 1</p> <p>REVISED:</p> <p>REVISED:</p>	<p>LAYOUT ORIENTATION</p> <p> <input type="checkbox"/> FREE STANDING <input checked="" type="checkbox"/> FULL RECESSED <input type="checkbox"/> LEFT RECESSED <input type="checkbox"/> RIGHT RECESSED </p>		
<p>MODEL: KC-22645-C</p> <p>DESIGNED FOR: CERES FARM LABOR 4 BEDROOM</p> <p><i>Palumbo</i></p>		<p>APPROVED SIGNATURE:</p> <p>_____</p>	

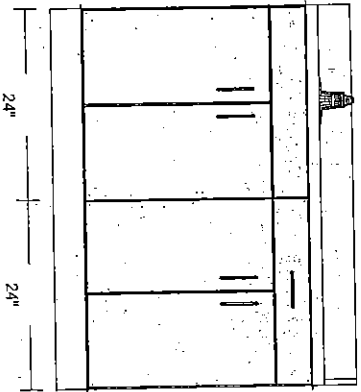
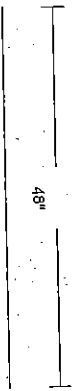
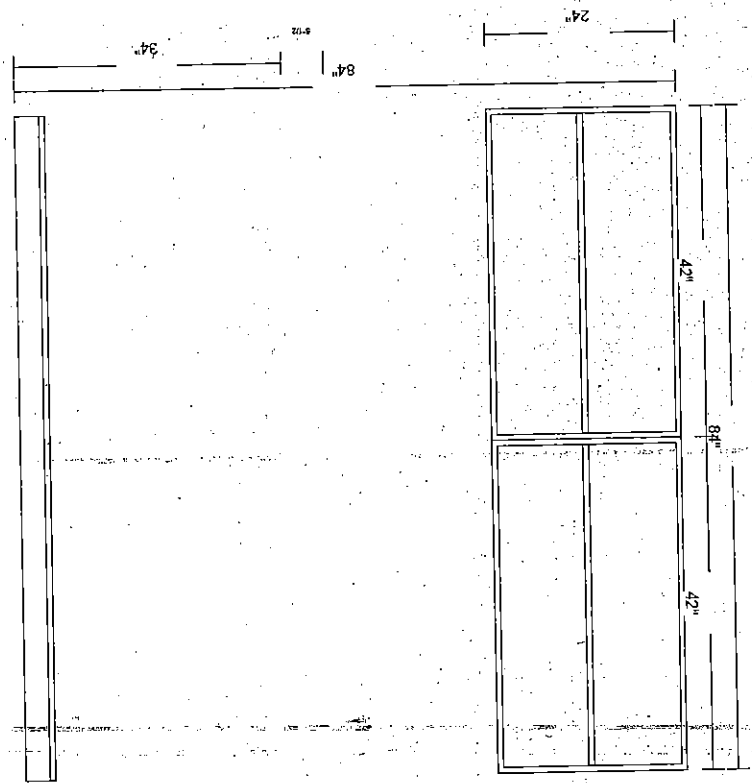
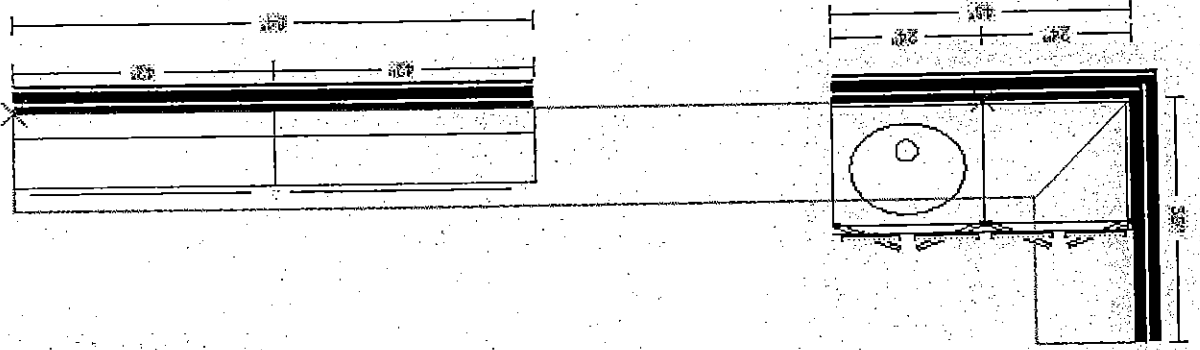

Housing Authority for County of Stanislaus
Pricing for Ceres Housing Upgrades - Building Type "D"

14 @ BUILDING TYPE "D"
2-BEDROOM DUPLEX APARTMENTS (28 Total Apartments)

CABINET TYPE	NUMBER OF CABINETS
Euro Kitchen (13.5 feet)	5 Base, 4 Upper
Euro Vanity BV48	2 Base
Euro Laundry W8424	2 Upper

3

RANGE AND COUNTERTOP SHOWN FOR ILLUSTRATION PURPOSES ONLY.

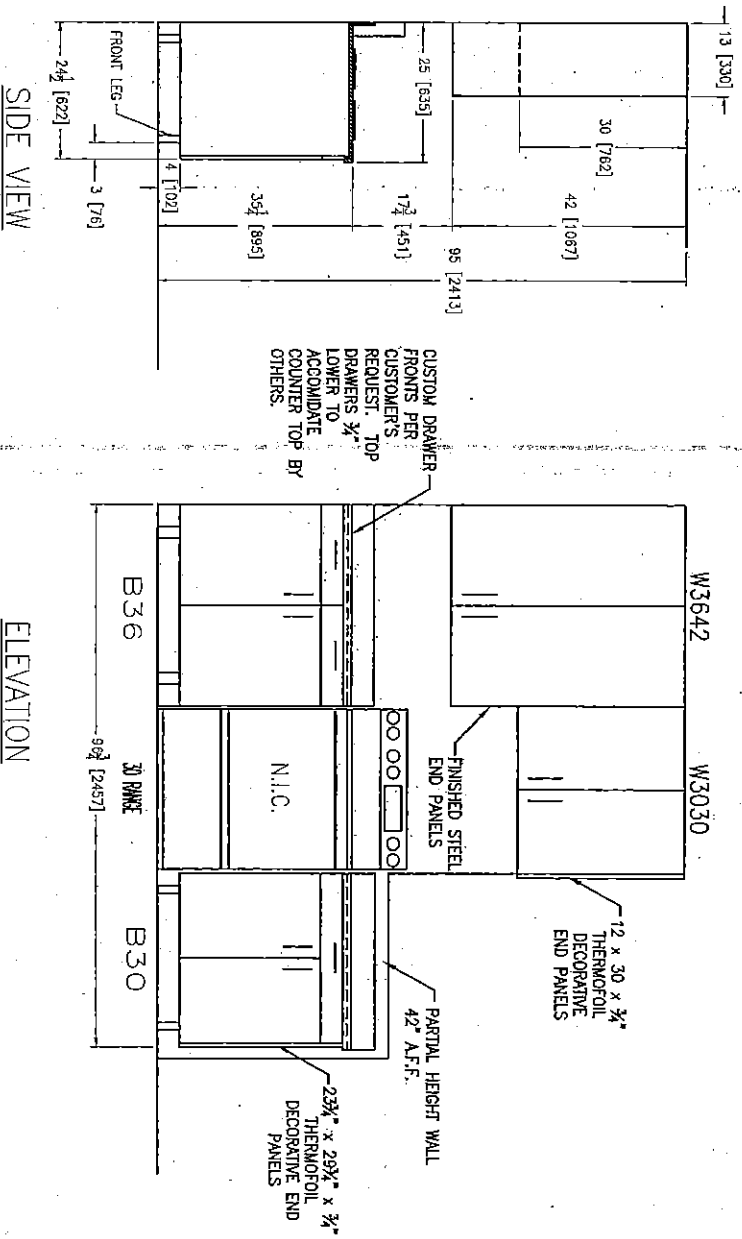

APPROVED SIGNATURE: _____

X _____

DRAWN: PH DATE: 10/01/09 REP.: 249

No. of Units: 1

REVISED:

REVISED:

Accessories:

Backwall Shield Material/Color: N/A

Endwall Shield Material/Color: N/A

Disposal: N/A

Under Cabinet Light: N/A

Range Hood Size/Color: N/A

KC-22646-D1

D-28 Gty
CERES FARM LABOR
3 BEDROOM UNIT

MODEL: D-28 Units

Cabinets

Cab box material	STEEL
Cab box color	TBD
Door material	THERMOFOIL
Door color	TBD
Door style	TBD
Countertop/Sink/Faucet	
Countertop material	N.I.C.
Color name/number	-
Sink type	-
Sink dimension	-
Faucet type	-
Faucet finish	-
Appliances	
Refrig type/color	N.I.C.
Range type/size	N.I.C.
Range color	N/A
Cooktop	N/A
Dishwasher size/color	N/A
Microwave type	N/A
Microwave size	N/A
Microwave color	N/A

Notes

1. For recessed units additional refrigerator space is needed. For door to open properly, allow 25-1/2" space total.
2. Kitchen cabinetry and appliances must be installed at finished floor height (for removability).
3. Refer to sheet 2 for roughing-in detail.
4. Specifications subject to change.
5. Linear dimensions are shown in inches and [millimeters].
6. Drawing is not drawn to scale.

Cabinets

Cab box material	STEEL
Cab box color	TBD
Door material	THERMOFOIL
Door color	TBD
Door style	TBD
Countertop/Sink/Faucet	
Countertop material	N.I.C.
Color name/number	-
Sink type	-
Sink dimension	-
Faucet type	-
Faucet finish	-

Appliances

Refrg type/color	N.I.C.
Range type/size	N.I.C.
Range color	N/A
Cooktop	N/A
Dishwasher size/color	N/A
Microwave type	N/A
Microwave size	N/A
Microwave color	N/A

Notes

1. For recessed units additional refrigerator space is needed. For door to open properly, allow 25-1/2" space total.
2. Kitchen cabinetry and appliances must be installed at finished floor height (for removability).
3. Refer to sheet 2 for roughing-in detail.
4. Specifications subject to change.
5. Linear dimensions are shown in inches and [millimeters].
6. Drawing is not drawn to scale.

FAUCET AND COUNTERTOPS SHOWN FOR ILLUSTRATION PURPOSES ONLY.

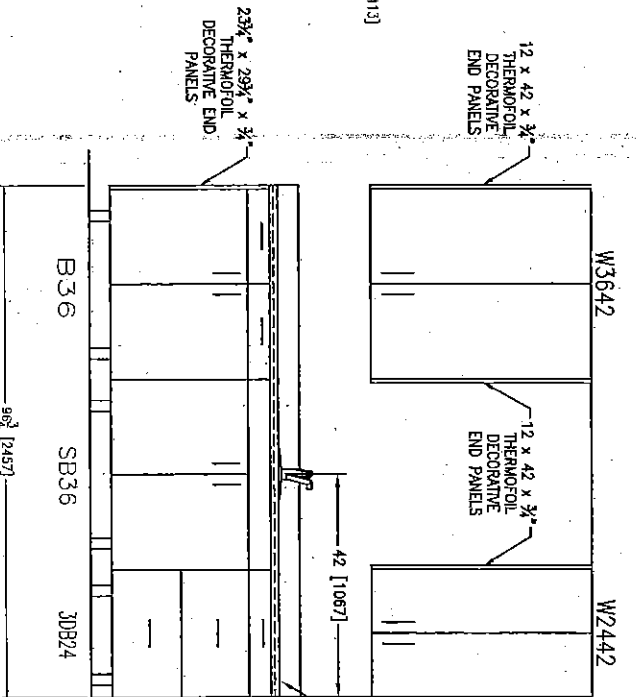
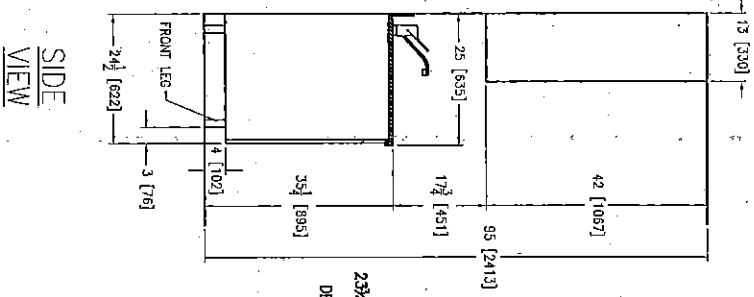

APPROVED SIGNATURE: _____

X

DRAWN: PH DATE: 10/01/09 REP.: 249

No. of Units: 1
 REVISED:
 REVISED:

Accessories:

Backwall Shield Material/Color	N/A
Endwall Shield material/Color	N/A
Disposal:	N/A
Under Cabinet Light:	N/A
Range Hood Size/Color	N/A

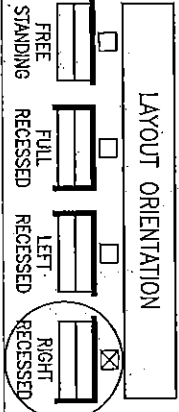

ELEVATION

Handwritten signature: *D 28 units*

KC-22646-D2

CUSTOM KITCHEN DESIGNED FOR:

CERES FARM LABOR 3 BEDROOM UNIT

MODEL: *D 28*

CUSTOM DRAWER FRONTS PER CUSTOMERS REQUEST. TOP DRAWERS 1/2" LOWER TO ACCOMMODATE COUNTERTOP BY OTHERS.

Cabinets	
Cab box material	STEEL
Cab box color	TBD
Door material	THERMOFOIL
Door color	TBD
Door style	TBD
Countertop/Sink/Faucet	
Countertop material	N.I.C.
Color name/number	-
Sink type	N/A
Sink dimension	-
Faucet type	N.I.C.
Faucet finish	-
Appliances	
Refrig type/color	N.I.C.
Range type/size	N.I.C.
Range color	-
Cooktop	N/A
Dishwasher size/color	N/A
Microwave type	N/A
Microwave size	N/A
Microwave color	N/A

- Notes**
- For recessed units additional refrigerator space is needed. For door to open properly, allow 25-1/2" space total.
 - Kitchen cabinetry and appliances must be installed at finished floor height (for removability).
 - Refer to sheet 2 for roughing-in detail.
 - Specifications subject to change.
 - Linear dimensions are shown in inches and [millimeters].
 - Drawing is not drawn to scale.

DRAWN: PH		DATE: 10/01/09	REP.: 249
No. of Units:		1	
REVISED:			
REVISED:			
Accessories:			
Backwall Shield Material/Color	N/A		
Endwall Shield material/Color	N/A		
Disposal:	N/A		
Under Cabinet Light:	N/A		
Range Hood Size/Color	N/A		
MODEL: D		KC-22646-D	
CUSTOM KITCHEN DESIGNED FOR:		CERES FARM WORKERS 3 BEDROOM UNIT	
© COPYRIGHT			

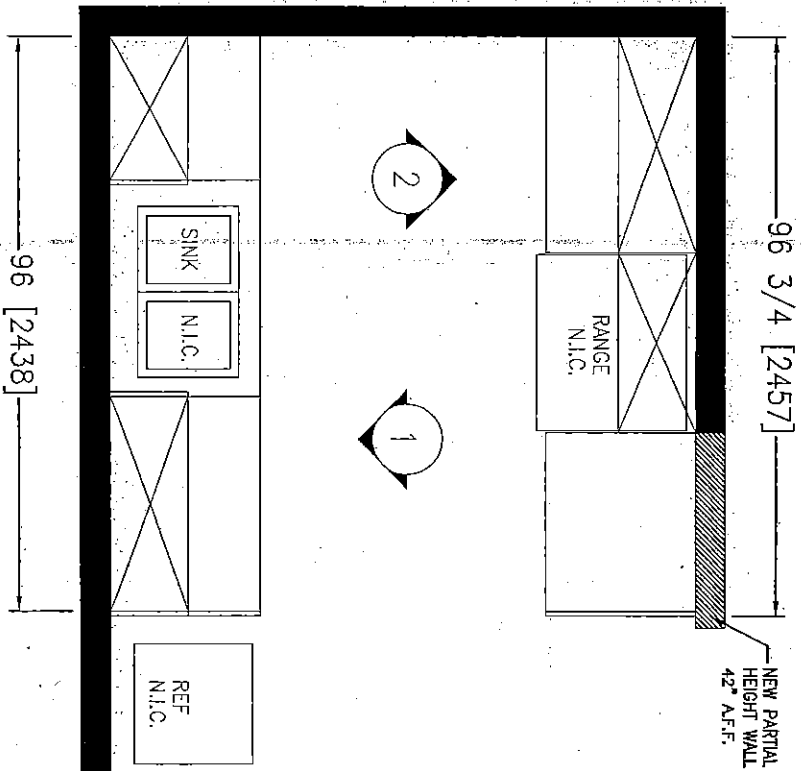

APPROVED SIGNATURE: _____

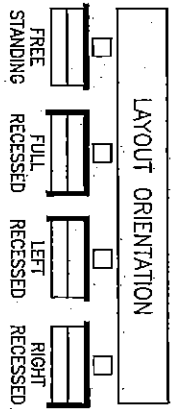

KC-22646-D

CUSTOM KITCHEN DESIGNED FOR:

CERES FARM WORKERS 3 BEDROOM UNIT

MODEL: D

Handwritten signature