

INVITATION FOR BID

BID #10894

The Housing Authority of the County of Stanislaus will receive bids for proposals for the purchase of cabinetry on 54 apartment units in Ceres, CA. Sealed bids will be received until 2:00p.m.on Wednesday March 10, 2010 at 1701 Robertson Road, Modesto CA. Sealed envelope should have the bid number, the bidder's name, along with attn: Juanita Nicholson. Bid package can be obtained at our web site www.stancoha.org.

The Housing Authority reserves the right to reject any or all bids or to waive any informality in the bidding. Bids may be held by the Authority for a period not to exceed 15 days from the date of the opening of bids for the propose of reviewing the bids and investigating the qualifications of the bidders prior to awarding the contract. No bids shall be withdrawn for a period of 60 days subsequent to the opening of bids without consent of the Housing authority of the County of Stanislaus.

The Housing Authority of the County of Stanislaus does not discriminate on the basis of disability in the admissions of access to, or treatment of employment in, its programs or activities.

The Housing Authority of the County of Stanislaus

Juanita Nicholson

Purchasing Specialist

STEEL CABINET:

- 1) Base and upper cabinet boxes net shall be fabricated using 20-gauge, electro-galvanized cold rolled steel with welded construction on sides, bottoms, back and tops (where applicable). Finish shall be a minimum 4-mil thickness of commercially applied powder coated material to all interior and exterior surfaces. (ASTM A591 standards).
- 2) Cabinet boxes shall conform to ANS/KCMA A161.1-2000, HUD Standards, and shall be GREENGUARD Indoor Air Quality Certified.
- 3) Adjustable steel shelving to ¾" (19mm) thick with rolled front edge and shall be secured by single pin, clear plastic shelf lock.
- 4) Drawers shall be constructed of 20-gauge powder coated steel with Dynaslide #7411019 or equal, full-extension steel drawer guides rated at a minimum, 100 lbs. be and equipped with metal roller bearings and a positive stop.
- 5) Cutting board shall be mounted using Accuride #AC340-176 or equal by width of drawer above, min. 15" wide per WIC standards.
- 6) Base cabinets shall have four adjustable legs and shall be securely fastened to the structure wall by the installation contractor. Area below base cabinet boxes and floor shall be covered with a minimum ½" thick solid wood or plywood manufactured with non-urea bonding agents and top-set base furnished by installation contractor.
- 7) ADA sink base cabinet shall have a minimum 30" clear area for wheelchair access.
- 8) Wall cabinets shall be mounted using hanging bracket systems furnished by the casework manufacturer.
- 9) Upper cabinet boxes shall be constructed with flush bottoms, except where a microwave or range hood is to be mounted to the underside of the cabinet

THERMOFOIL CABINET DOORS/DRAWERS & FINISH END PANELS

- 1) Shall be constructed of a ¾" [19mm] thick medium density fiberboard (MDF) substrate with a seamless, 16 mm thick, rigid thermofoil material heated and applied with top pressure and bottom vacuum to front and edge surfaces. The backing (interior finish) shall be white thermo-fused melamine laminate.
- 2) All thermofoil components shall conform to ANS/KCMA A161. 1-2000 and HUD Standards, and shall be GREENGUARD Indoor Air Quality Certified.
- 3) Cabinet hinges shall be Grass Nexis 110 Series #NX73 VS 110G42 concealed European-type or equal, self closing with 110 degree opening angle, stamped steel arm and 6-way adjustability.
- 4) Thermofoil panel (cabinet doors, drawer faces & end panels) shall be slab style with oak or maple finish color (as selected from full range of manufacturer's standard patterns).

ROUGH HARDWARE

- 1) General: Furnish all items necessary for the installation of the manufactured metal casework and laminate countertops, whether or not specifically described.
- 2) Nails: FS FF-N-105. Finishing nails for interior trim, as necessary.

- 3) Nails: FS FF-N-105. Finishing nails for interior trim, as necessary.
- 4) Screws: FS FF-S-111, except use self-drilling, self taping, type S drywall screws for attachment of finish materials to gypsum drywall.
- 5) Bolts: FS FF-B-58.
- 6) Lag screws and bolts: FS FF-B-561.
- 7) Toggle bolts: FS FF-B-588 galvanized.
- 8) Self-drilling anchors: Equal to Phillips "Red Head", S or F series, FS FF-S-325, group 111, Type 1.
- 9) Provide vinyl covers to cover exposed screw heads.
- 10) Provide other materials, not specifically described but required for complete and proper installation, as selected by the Contractor subject to the approval of the Architect.

EXECUTION

- 1) Fabrication: Fabricate all countertops and casework in strict accordance with approved shop drawings and applicable standards. W.I.C. certificates for the countertops are NOT required.
- 2) Provide Thermofoil or Plastic Laminate scribe at all joints with dissimilar materials where required to close gaps.
- 3) Make scribed joints close and accurate. Install all work to details shown, plumb, level properly located and aligned. Hammer marks on exposed finished surfaces will be considered cause for rejection of work..

COUNTERTOPS:

- 1) Fabricate all countertops in strict accordance with approved Shop Drawings and referenced standards.
- 2) Cut openings in countertops and casework for equipment which is to be installed under other Sections of these Specifications. Verify size and locations of openings with other trades prior to making openings. Provide grommets at openings in compatible color or metal as approved.

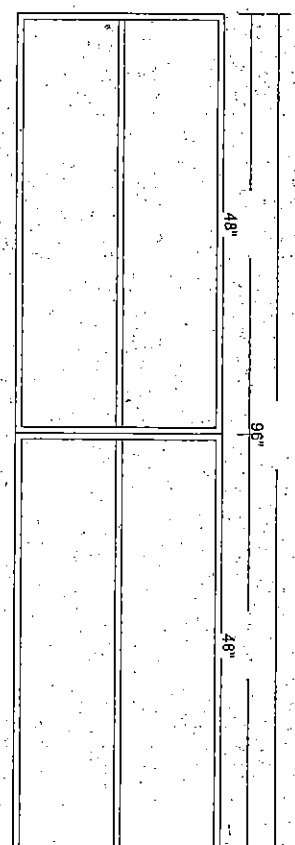
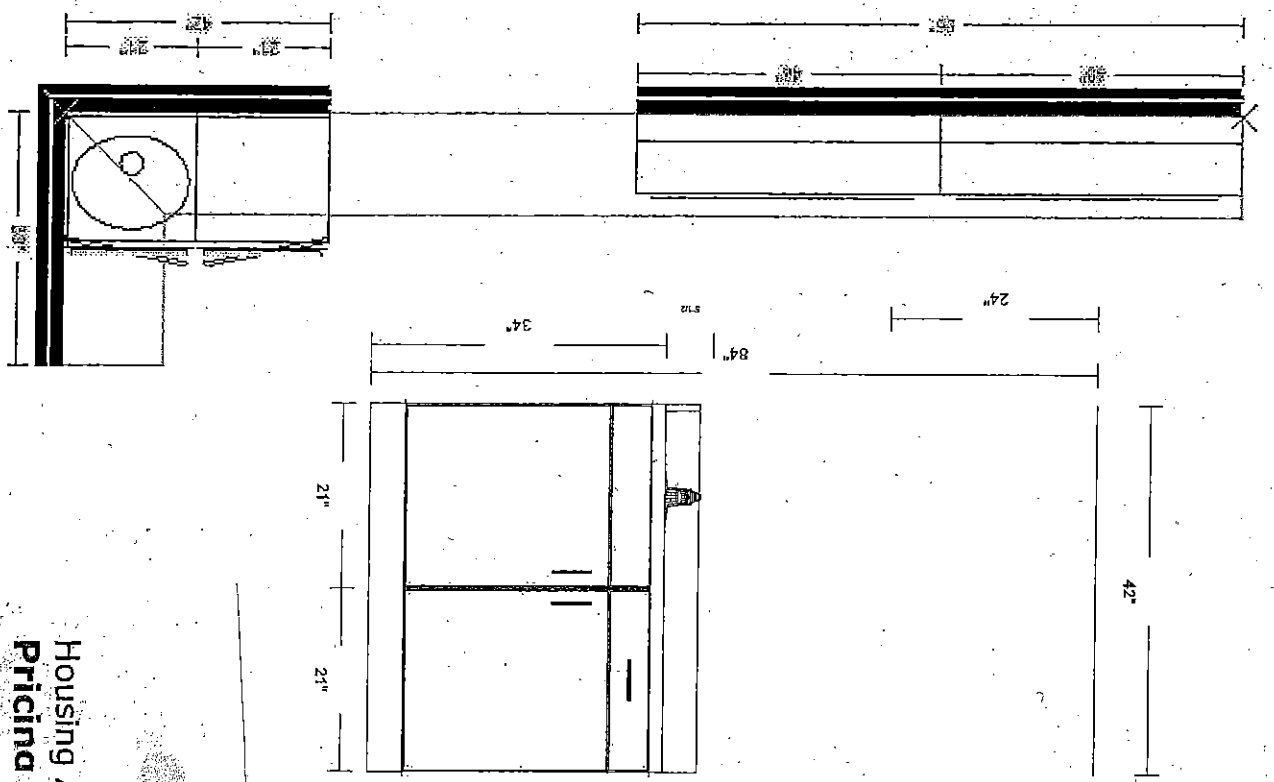

Housing Authority for County of Stanislaus
Pricing for Ceres Housing Upgrades - Building Type "A"

4 @ BUILDING TYPE "A"
2-BEDROOM DUPLEX APARTMENTS (8 Total Apartments)

CABINET TYPE	NUMBER OF CABINETS
Euro Kitchen (17.5 feet)	5 Base, 7 Upper
Euro Vanity BV42	2 Base
Euro Laundry W9624	2 Upper

Cabinets

Cab box material	STEEL
Cab box color	TBD
Door material	THERMOFOL
Door color	TBD
Door style	TBD
Countertop/Sink/Faucet	N.I.C.
Color name/number	-
Sink type	-
Sink dimension	-
Faucet type	N.I.C.
Faucet finish	-

Appliances

Refrig type/color	N.I.C.
Range type/size	N.I.C.
Range color	N/A
Cooktop	N/A
Dishwasher size/color	N/A
Microwave type	N/A
Microwave size	N/A
Microwave color	N/A

Notes

1. For recessed units additional refrigerator space is needed. For door to open properly, allow 25-1/2" space total.
2. Kitchen cabinetry and appliances must be installed at finished floor height (for removability).
3. Refer to sheet 2 for roughing-in detail.
4. Specifications subject to change.
5. Linear dimensions are shown in inches and [millimeters].
6. Drawing is not drawn to scale.

ALL APPLIANCES AND COUNTERTOPS SHOWN FOR ILLUSTRATION PURPOSES ONLY.

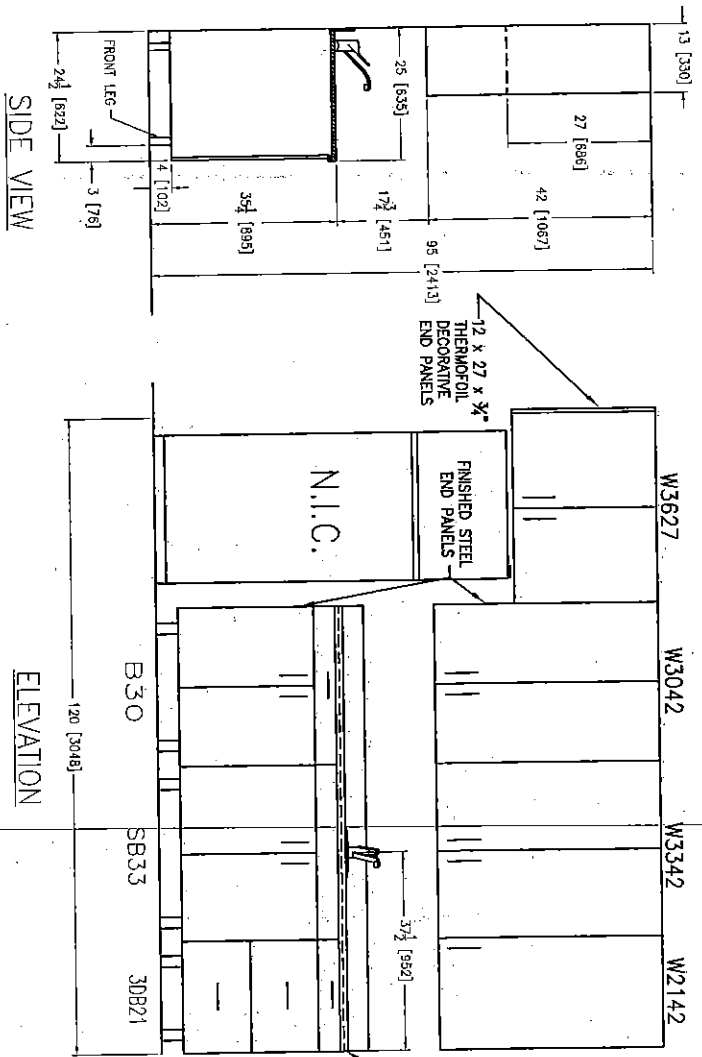

APPROVED SIGNATURE: _____

X

DRAWN: PH DATE: 10/07/09 REP.: 249

No. of Units: 1

REVISED:

REVISED:

Accessories:

Backwall Shield Material/Color: N/A

Endwall Shield material/Color: N/A

Disposal: N/A

Under Cabinet Light: N/A

Range Hood Size/Color: -

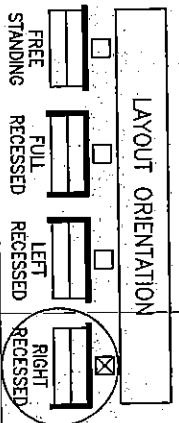

KC-22647-B1

CUSTOM KITCHEN DESIGNED FOR:

CERES FARM LABOR 2 BEDROOM UNIT

MODEL: A-Blanco

ALL APPLIANCES AND COUNTERTOP SHOWN FOR ILLUSTRATION PURPOSES ONLY.

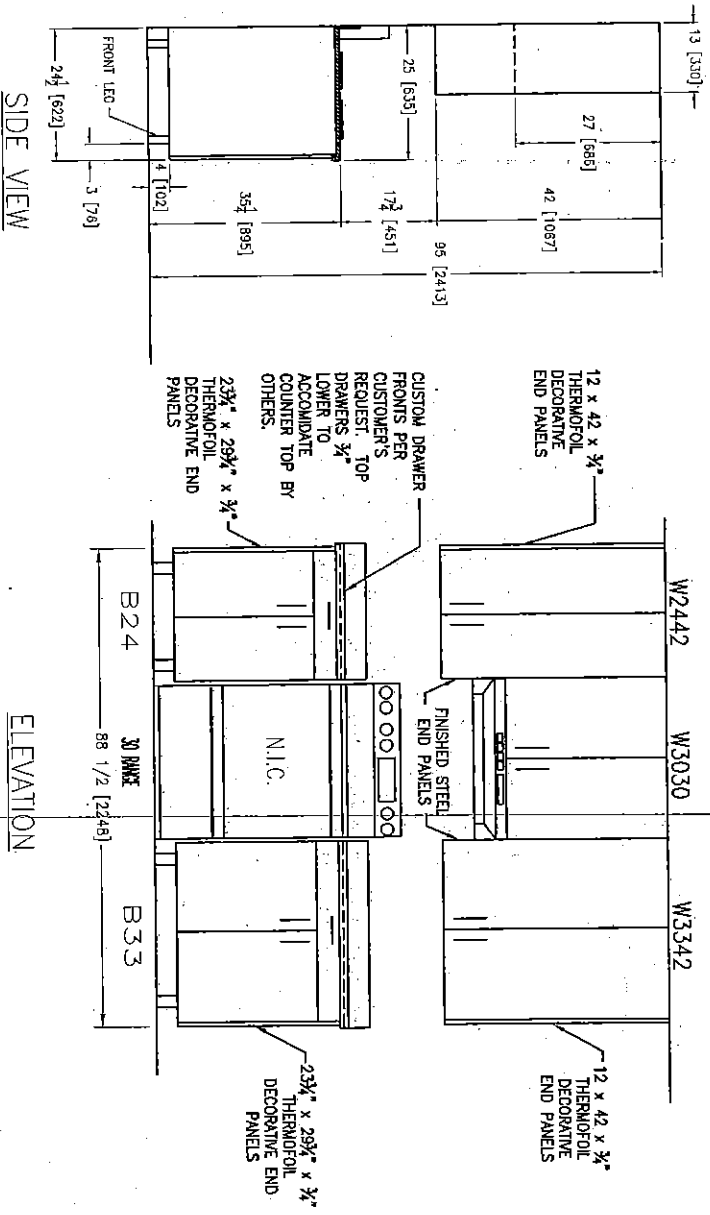

Cabinets	
Cab box material	STEEL
Cab box color	TBD
Door material	THERMOFOIL
Door color	TBD
Door style	TBD
Countertop/Sink/Faucet	
Countertop material	N.I.C.
Color name/number	-
Sink type	-
Sink dimension	-
Faucet type	-
Faucet finish	-
Appliances	
Refrig type/color	N.I.C.
Range type/size	N.I.C.
Range color	N/A
Cooktop	N/A
Dishwasher size/color	N/A
Microwave type	N/A
Microwave size	N/A
Microwave color	N/A

- Notes**
1. For recessed units additional refrigerator space is needed. For door to open properly, allow 25-1/2" space total.
 2. Kitchen cabinetry and appliances must be installed at finished floor height (for removability).
 3. Refer to sheet 2 for roughing-in detail.
 4. Specifications subject to change.
 5. Linear dimensions are shown in inches and [millimeters].
 6. Drawing is not drawn to scale.

APPROVED SIGNATURE: _____

DRAWN: PH DATE: 10/07/09 REP.: 249

No. of Units: 1
 REVISED:
 REVISED:

Accessories:

Backwall Shield Material/Color	N/A
Endwall Shield material/Color	N/A
Disposal:	N/A
Under Cabinet Light:	N/A
Range Hood Size/Color	N/A

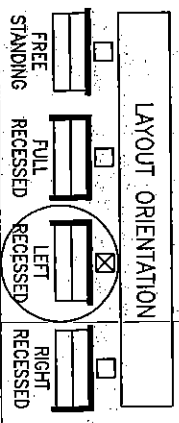

KC-22647-B2

CUSTOM KITCHEN DESIGNED FOR:

CERES FARM LABOR 2 BEDROOM UNIT

MODEL: *A-Slants*

Cabinets	
Cab box material	STEEL
Cab box color	TBD
Door material	THERMOFOIL
Door color	TBD
Door style	TBD
Countertop/Sink/Faucet	
Countertop material	N.I.C.
Color name/number	-
Sink type	-
Sink dimension	-
Faucet type	-
Faucet finish	-
Appliances	
Refrig. type/color	-
Range type/size	N.I.C.
Range color	-
Cooktop	N/A
Dishwasher size/color	N/A
Microwave type	N/A
Microwave size	N/A
Microwave color	N/A

Notes

1. For recessed units additional refrigerator space is needed. For door to open properly, allow 25-1/2" space total.
2. Kitchen cabinetry and appliances must be installed at finished floor height (for removability).
3. Refer to sheet 2 for roughing-in detail.
4. Specifications subject to change.
5. Linear dimensions are shown in inches and [millimeters].
6. Drawing is not drawn to scale.

DRAWN: PH		DATE: 10/01/09	REP.: 249	Accessories:		KC-22647-B	
No. of Units: 1		Backwall Shield MATERIAL/Color: N/A		Endwall Shield material/Color: N/A		Disposal: N/A	
REVISSED:		Under Cabinet Light: N/A		Range Hood Size/Color: 30"		CUSTOM KITCHEN DESIGNED FOR: CERES-FARM WORKERS 2 BEDROOM UNIT	
REVISSED:		Range Hood Size/Color: 30"		MODEL: A-81466			

APPROVED SIGNATURE: _____

X

PLAN VIEW

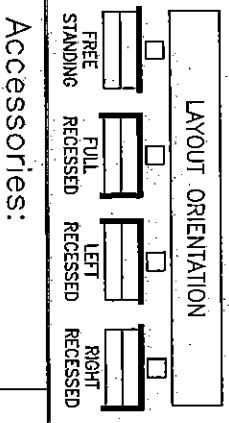
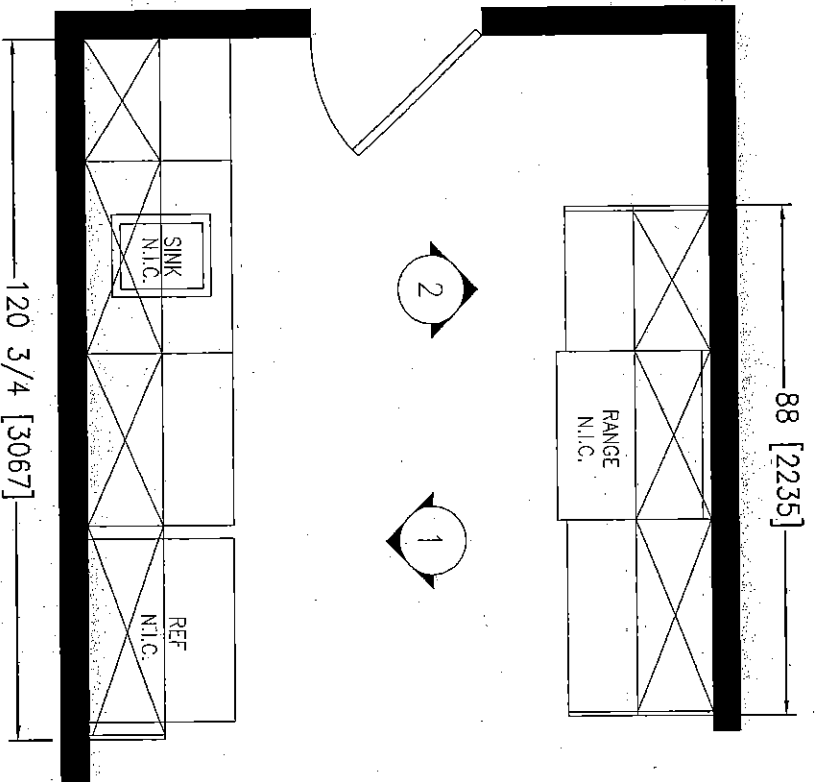

CUSTOM KITCHEN DESIGNED FOR:
 CERES-FARM WORKERS
 2 BEDROOM UNIT
MODEL: A-81466

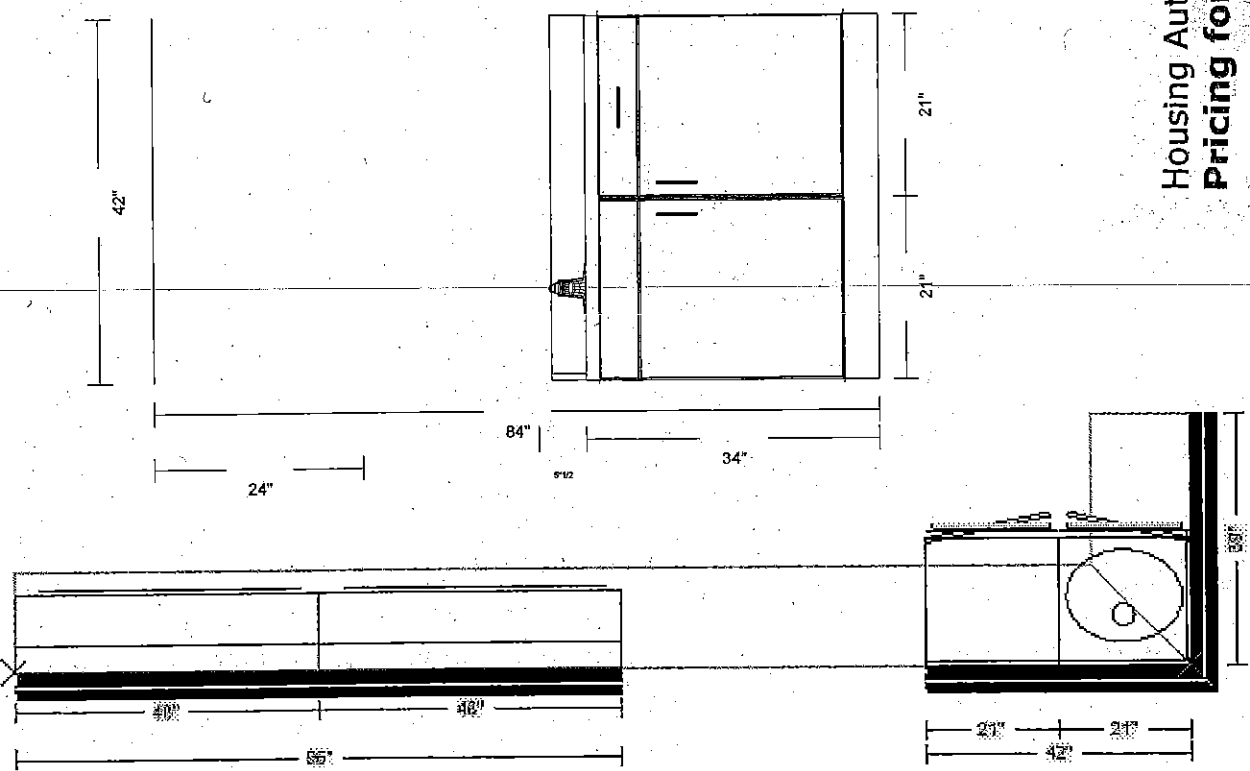
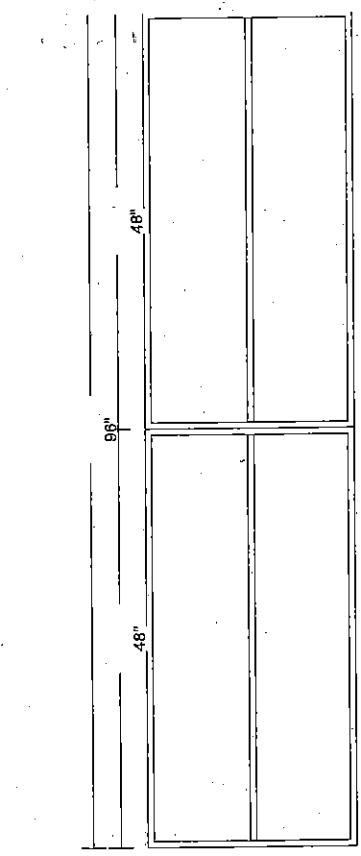

Housing Authority for County of Stanislaus
Pricing for Ceres Housing Upgrades - Building Type "B"

3 @ BUILDING TYPE "B"
2-BEDROOM DUPLEX APARTMENTS (6 Total Apartments)

CABINET TYPE	NUMBER OF CABINETS
Euro Kitchen (20.5 feet)	5 Base, 7 Upper
Euro Vanity BV42	2 Base
Euro Laundry W9624	2 Upper

ALL APPLIANCES AND COUNTERTOPS SHOWN FOR ILLUSTRATION PURPOSES ONLY.

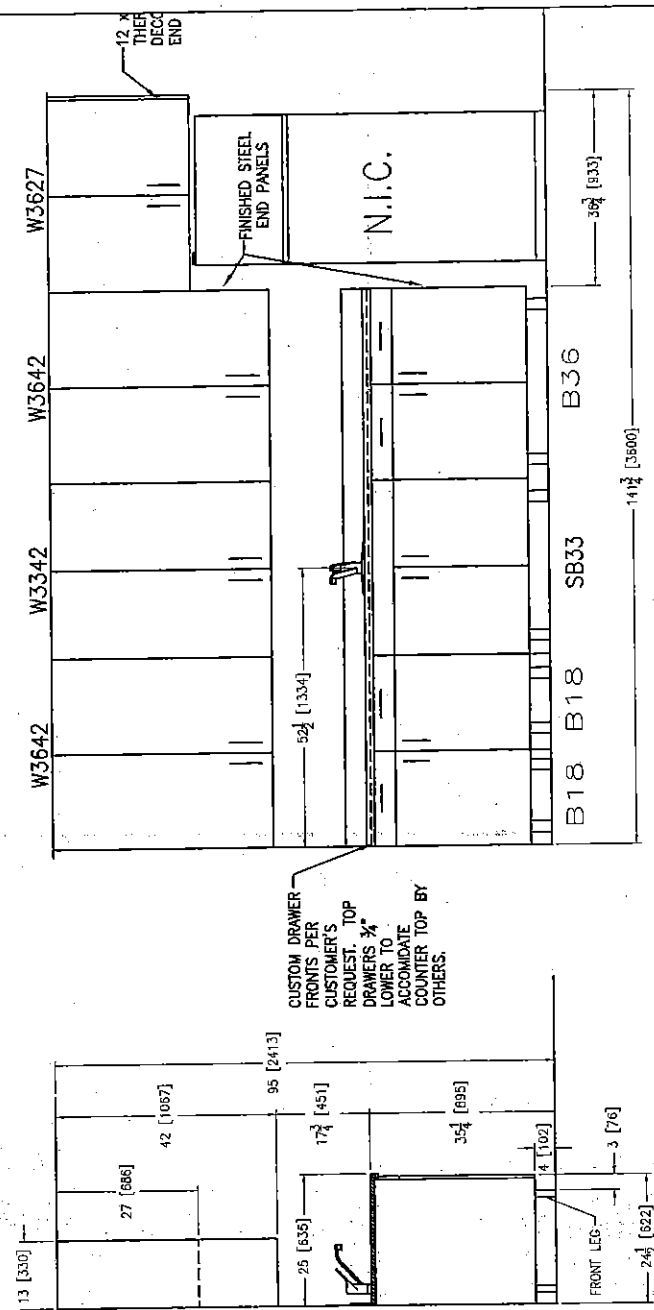

ELEVATION

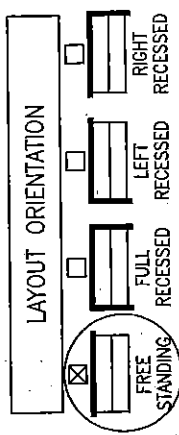

APPROVED SIGNATURE: X

DRAWN: PH	DATE: 10/01/09	REP.: 249	Accessories:	KC-22647-A1
No. of Units: 8			Backwall Shield Material/Color	N/A
REVISOR: OVERALL DIMENSIONS REVISED/ CABINETS ADDED 09/25/09			Endwall Shield material/Color	N/A
REVISOR:			Disposal:	N/A
			Under Cabinet Light:	N/A
			Range Hood Size/Color	-
			CUSTOM KITCHEN DESIGNED FOR:	CERES FARM LABOR 2 BEDROOM UNIT
			MODEL	B Cabinets

Cabinets	
Cab box material	STEEL
Cab box color	TBD
Door material	THERMOFOIL
Door color	TBD
Door style	TBD
Countertop/Sink/Faucet	
Countertop material	N.I.C.
Color name/number	-
Sink type	-
Sink dimension	-
Faucet type	N.I.C.
Faucet finish	-
Appliances	
Refrig type/color	N.I.C.
Range type/size	N.I.C.
Range color	N/A
Cooktop	N/A
Dishwasher size/color	N/A
Microwave type	N/A
Microwave size	N/A
Microwave color	N/A

Notes

- For recessed units additional refrigerator space is needed. For door to open properly, allow 25-1/2" space total.
- Kitchen cabinetry and appliances must be installed at finished floor height (for removability).
- Refer to sheet 2 for roughing-in detail.
- Specifications subject to change.
- Linear dimensions are shown in inches and [millimeters].
- Drawing is not drawn to scale.

ALL APPLIANCES AND COUNTERTOP SHOWN FOR ILLUSTRATION PURPOSES ONLY.

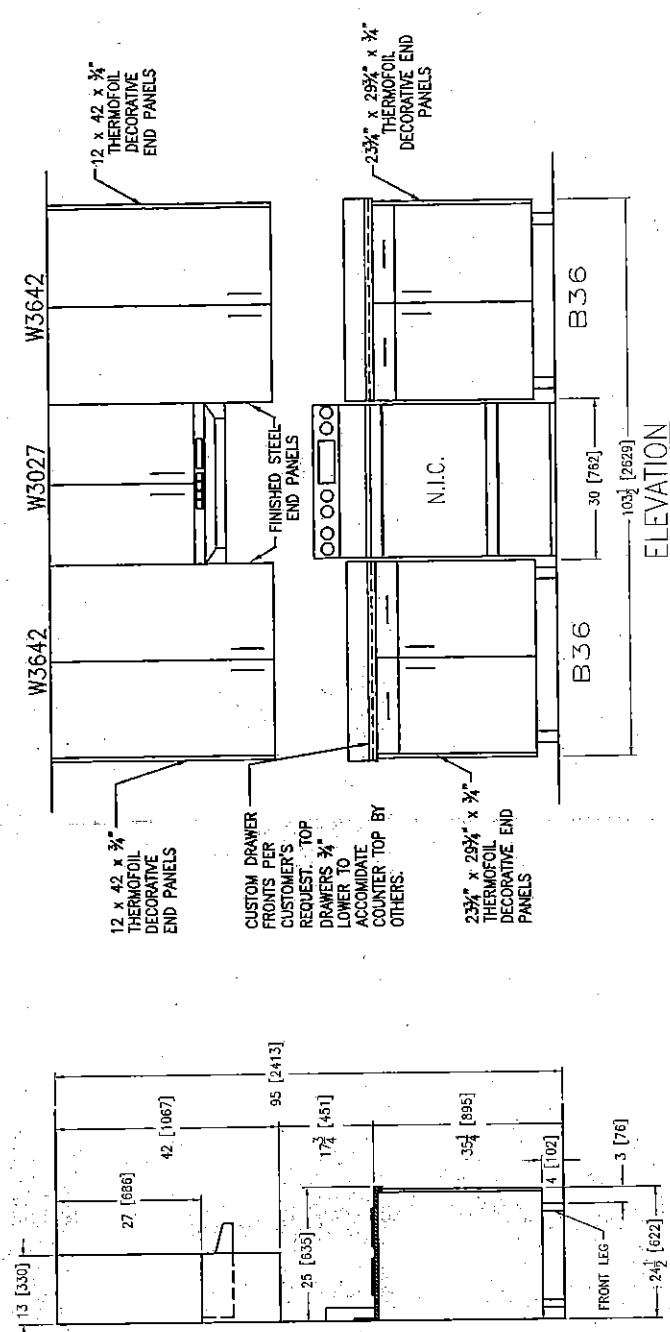

SIDE VIEW

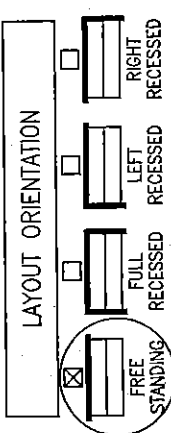

© COPYRIGHT

KC-22647-A2
 CUSTOM KITCHEN
 DESIGNED FOR:
 CERES FARM LABOR
 2 BEDROOM UNIT

MODEL: B *Calvin*

APPROVED SIGNATURE:
 X

DRAWN: PH DATE: 10/01/09 REP.: 249

No. of Units: 8

REVISID: OVERALL DIMENSIONS REVISED/ CABINETS SIZES REVISED 09/25/09

REVISID:

Accessories:

Backwall Shield Material/Color	N/A
Endwall Shield material/Color	N/A
Disposal:	N/A
Under Cabinet Light:	N/A
Range Hood Size/Color	N/A

Cabinets	
Cab. box material	STEEL
Cab. box color	TBD
Door material	THERMOFOIL
Door color	TBD
Door style	TBD
Countertop/Sink/Faucet	
Countertop material	N.I.C.
Color name/number	-
Sink type	-
Sink dimension	-
Faucet type	-
Faucet finish	-
Appliances	
Refrig type/color	N.I.C.
Range type/size	N.I.C.
Range color	N/A
Cooktop	N/A
Dishwasher size/color	N/A
Microwave type	N/A
Microwave size	N/A
Microwave color	N/A

Notes

- For recessed units additional refrigerator space is needed. For door to open properly, allow 25-1/2" space total.
- Kitchen cabinetry and appliances must be installed at finished floor height (for removability).
- Refer to sheet 2 for roughing-in detail.
- Specifications subject to change.
- Linear dimensions are shown in inches and [millimeters].
- Drawing is not drawn to scale.

Cabinets

Cab. box material	STEEL
Cab. box color	TBD
Door material	THERMOFOIL
Door color	TBD
Door style	TBD

Countertop/Sink/Faucet

Countertop material	N.I.C.
Color name/number	-
Sink type	-
Sink dimension	-
Faucet type	-
Faucet finish	-

Appliances

Refrig type/color	-
Range type/size	N.I.C.
Range color	-
Cooktop	N/A
Dishwasher size/color	N/A
Microwave type	N/A
Microwave size	N/A
Microwave color	N/A

Notes

1. For recessed units additional refrigerator space is needed. For door to open properly, allow 25-1/2" space total.
2. Kitchen cabinetry and appliances must be installed at finished floor height (for removability).
3. Refer to sheet 2 for roughing-in detail.
4. Specifications subject to change.
5. Linear dimensions are shown in inches and [millimeters].
6. Drawing is not drawn to scale.

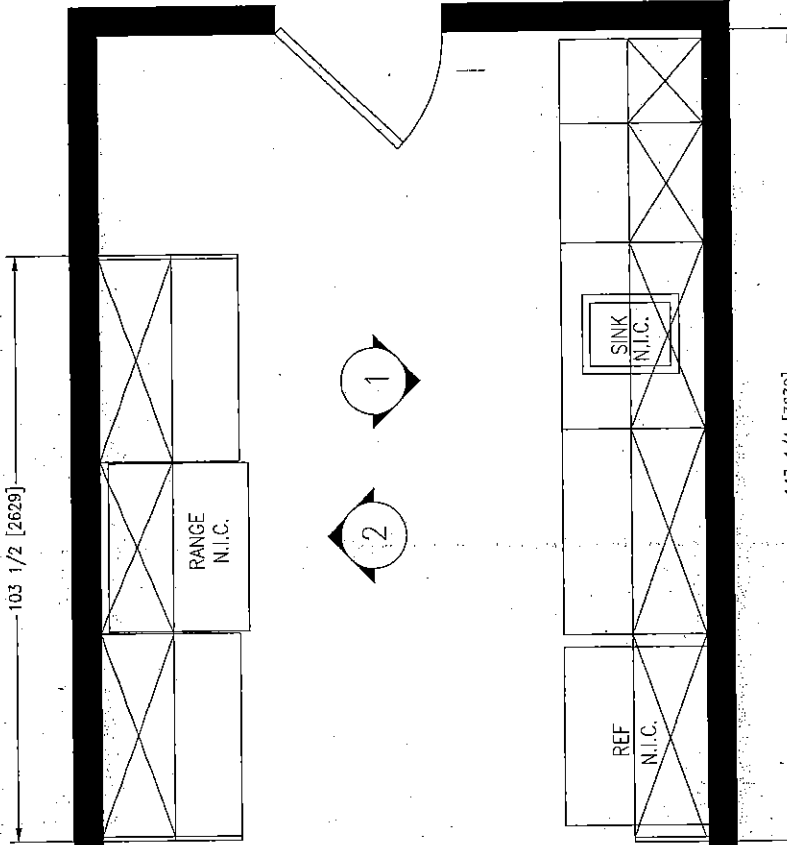

PLAN VIEW

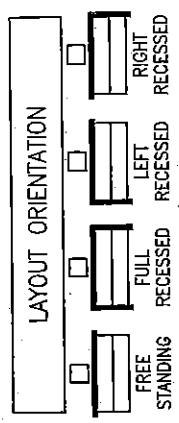

APPROVED SIGNATURE: X

DRAWN: PH	DATE: 10/01/09	REP.: 249	Accessories:	KC-22647-A
No. of Units:	8		Backwall Shield MATERIAL/Color	N/A
REVISED:			Endwall Shield material/Color	N/A
REVISED:			Disposal:	N/A
			Under Cabinet Light:	N/A
			Range Hood Size/Color	30"

CUSTOM KITCHEN DESIGNED FOR:

CERES FARM WORKERS
2 BEDROOM UNIT

MODEL: B-*Colanto*

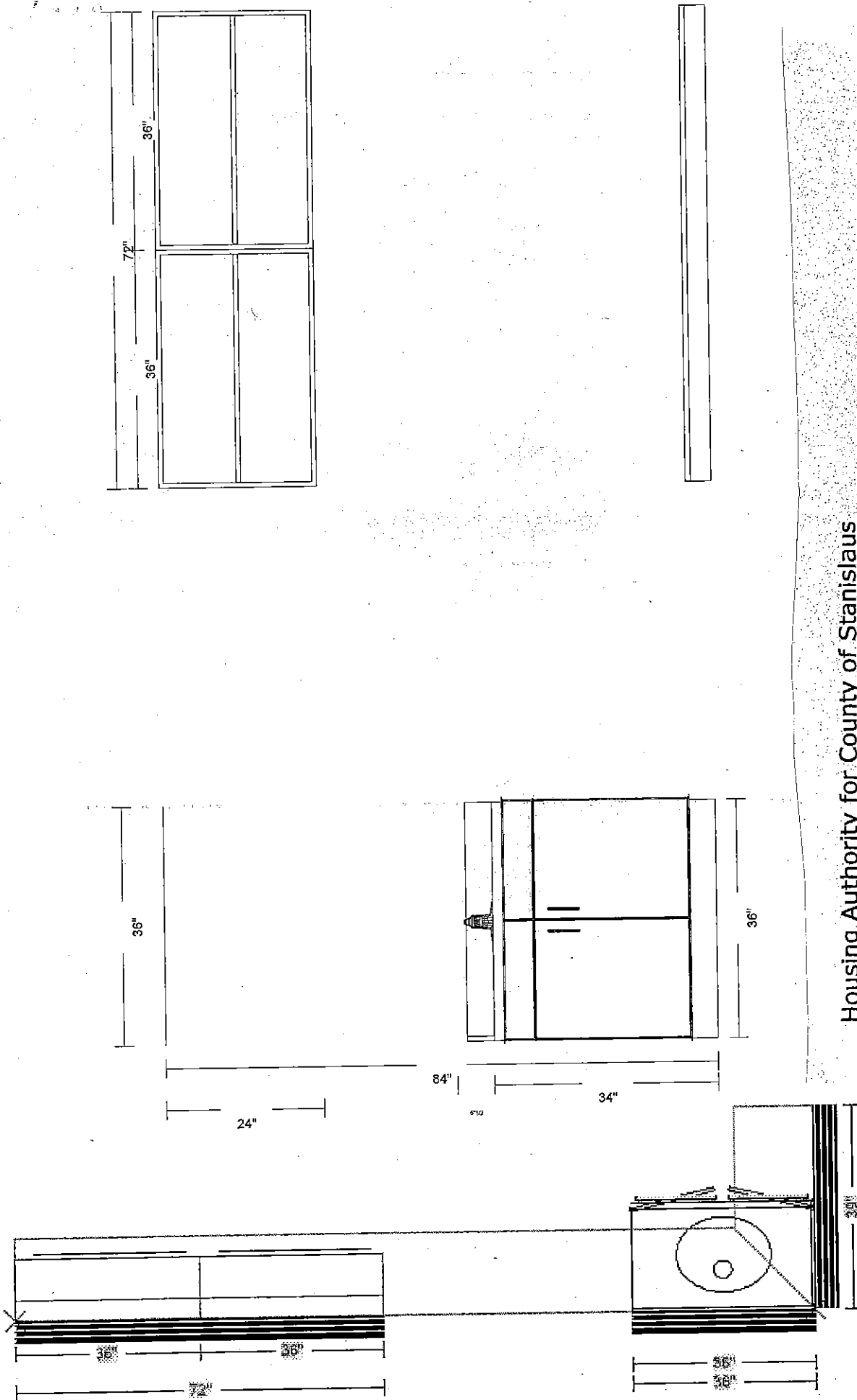

Housing Authority for County of Stanislaus
Pricing for Ceres Housing Upgrades - Building Type "C"

6 @ BUILDING TYPE "C"
4-BEDROOM DUPLEX APARTMENTS (12 Total Apartments)

CABINET TYPE	NUMBER OF CABINETS
Euro Kitchen (24 feet)	7 Base, 8 Upper
Euro Vanity 2@ BV36	2 Base
Euro Laundry W7224	2 Upper

ALL APPLIANCES AND COUNTERTOP SHOWN FOR ILLUSTRATION PURPOSES ONLY.

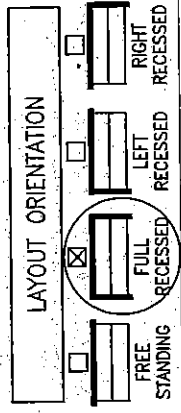
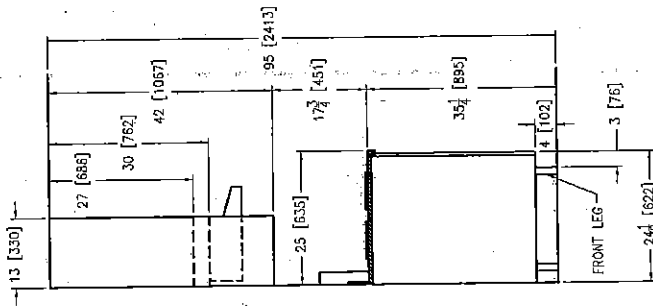
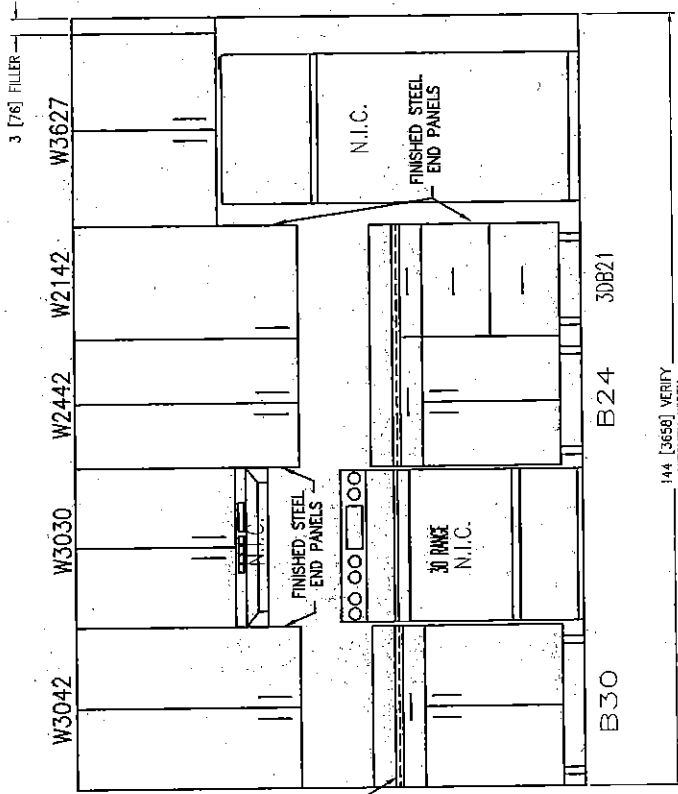

APPROVED SIGNATURE: X

Cabinets	
Cab box material	STEEL
Cab box color	TBD
Door material	THERMOFOIL
Door color	TBD
Door style	TBD
Countertop/Sink/Faucet	
Countertop material	N.I.C.
Color name/number	-
Sink type	-
Sink dimension	-
Faucet type	-
Faucet finish	-
Appliances	
Refrig type/color	N.I.C.
Range type/size	N.I.C.
Range color	N/A
Cooktop	N/A
Dishwasher size/color	N/A
Microwave type	N/A
Microwave size	N/A
Microwave color	N/A

Notes	
1. For recessed units additional refrigerator space is needed. For door to open properly, allow 25-1/2" space total.	
2. Kitchen cabinetry and appliances must be installed at finished floor height (for removability).	
3. Refer to sheet 2 for roughing-in detail.	
4. Specifications subject to change.	
5. Linear dimensions are shown in inches and [millimeters].	
6. Drawing is not drawn to scale.	

DRAWN: PH	DATE: 10/01/08	REP.: 249	Accessories:	KC- 22645-C1
No. of Units:	1		Backwall Shield Material/Color	N/A
REVISED:			Endwall Shield material/Color	N/A
REVISED:			Disposal:	N/A
			Under Cabinet Light:	N/A
			Range Hood Size/Color	N/A
			CUSTOM KITCHEN DESIGNED FOR:	CERES FARM LABOR 4-BEDROOM UNIT
			MODEL:	C 12 units

FAUCET AND COUNTERTOP SHOWN FOR ILLUSTRATION PURPOSES ONLY.

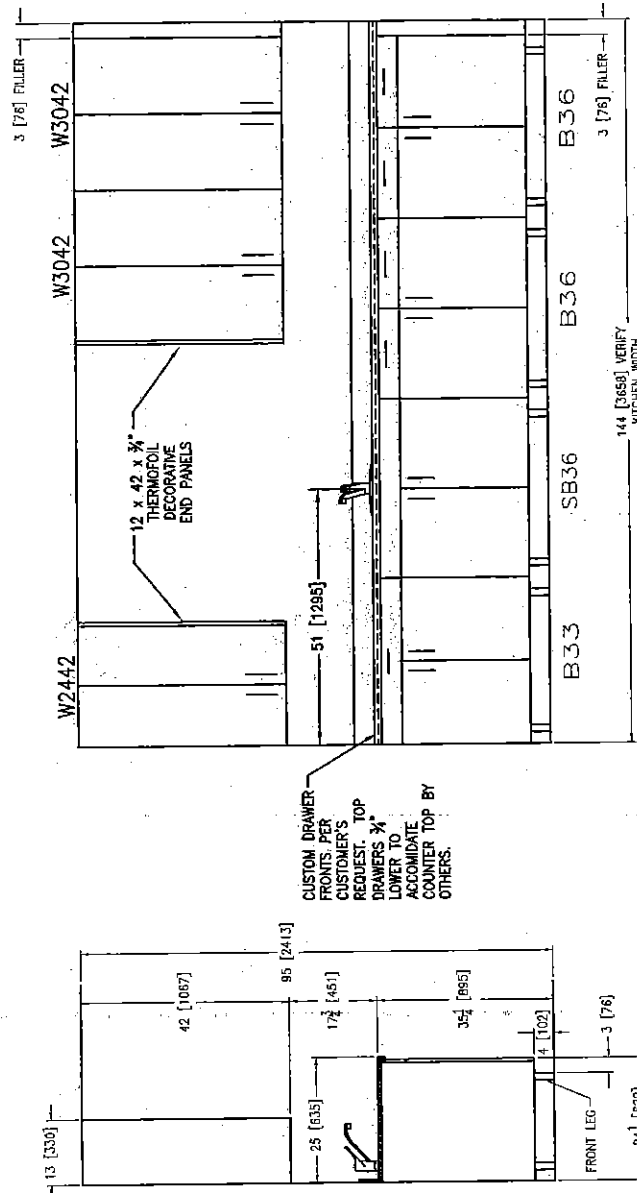

SIDE VIEW

ELEVATION

FAUCET SHOWN FOR ILLUSTRATION PURPOSES ONLY.

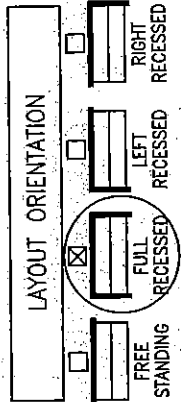

APPROVED SIGNATURE: X

Accessories: KC-- 22645-C2
CUSTOM KITCHEN DESIGNED FOR:
 CERES FARM-LABOR
 4 BEDROOM
MODEL: *C Units*

Cabinets	
Cab box material	STEEL
Cab box color	TBD
Door material	THERMOFOIL
Door color	TBD
Door style	TBD
Countertop/Sink/Faucet	
Countertop material	N.I.C.
Color name/number	-
Sink type	-
Sink dimension	-
Faucet type	N.I.C.
Faucet finish	-
Appliances	
Refrig type/color	N/A
Range type/size	N/A
Range color	N/A
Cooktop	N/A
Dishwasher size/color	N/A
Microwave type	N/A
Microwave size	N/A
Microwave color	N/A

Notes

- For recessed units additional refrigerator space is needed. For door to open properly, allow 25-1/2" space total.
- Kitchen cabinetry and appliances must be installed at finished floor height (for removability).
- Refer to sheet 2 for roughing-in detail.
- Specifications subject to change.
- Linear dimensions are shown in inches and [millimeters].
- Drawing is not drawn to scale.

DRAWN: PH	DATE: 10/01/09	REP.: 249
No. of Units:	1	
REVISED:		
REVISED:		

Backwall Shield Material/Color	N/A
Endwall Shield material/Color	N/A
Disposal:	N/A
Under Cabinet Light:	N/A
Range Hood Size/Color	N/A

Cabinets	
Cab box material	STEEL
Cab box color	TBD
Door material	THERMOFOIL
Door color	TBD
Door style	TBD
Countertop/Sink/Faucet	
Countertop material	N.I.C.
Color name/number	N/A
Sink type	N.I.C.
Sink dimension	-
Faucet type	N.I.C.
Faucet finish	-
Appliances	
Refrig type/color	N.I.C.
Range type/size	-
Range color	N.I.C.
Cooktop	N/A
Dishwasher size/color	N/A
Microwave type	N/A
Microwave size	N/A
Microwave color	N/A

Notes	
1. For recessed units additional refrigerator space is needed. For door to open properly, allow 25-1/2" space total.	
2. Kitchen cabinetry and appliances must be installed at finished floor height (for removability).	
3. Refer to sheet 2 for roughing-in detail.	
4. Specifications subject to change.	
5. Linear dimensions are shown in inches and [millimeters].	
6. Drawing is not drawn to scale.	

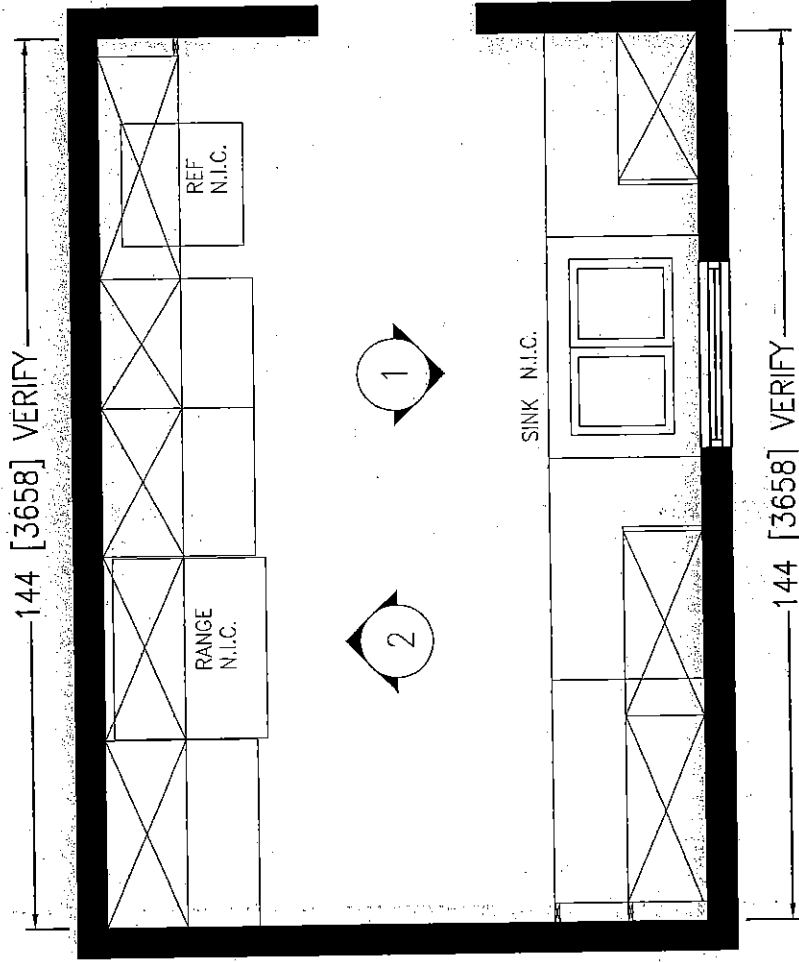

PLAN VIEW

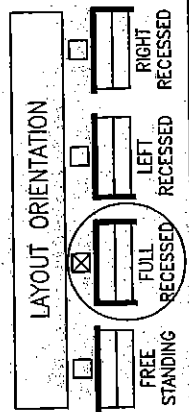

APPROVED SIGNATURE: _____

X

DRAWN: PH	DATE: 10/01/09	REP.: 249	Accessories:	KC-22645-C
No. of Units:	1		Backwall Shield Material/Color	N/A
REVISED:			Endwall Shield material/Color	N/A
REVISED:			Disposal:	N/A
			Under Cabinet Light:	N/A
			Range Hood Size/Color	N/A
CUSTOM KITCHEN DESIGNED FOR:				
CERES FARM LABOR				
4-BEDROOM				
MODEL: C-Plumto				

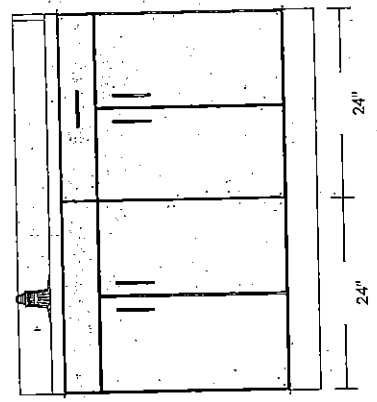
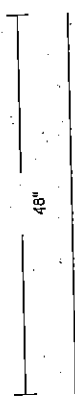
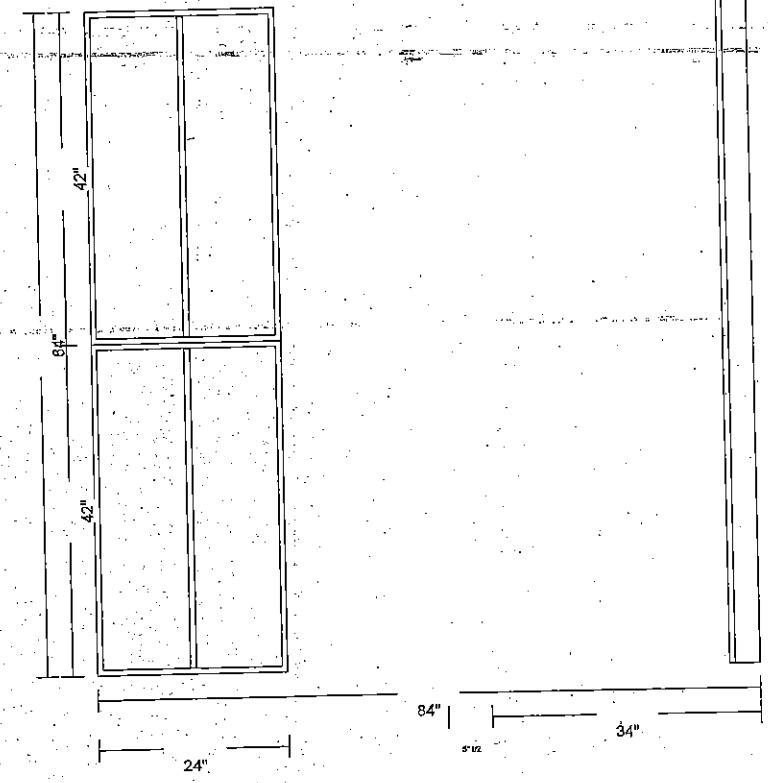
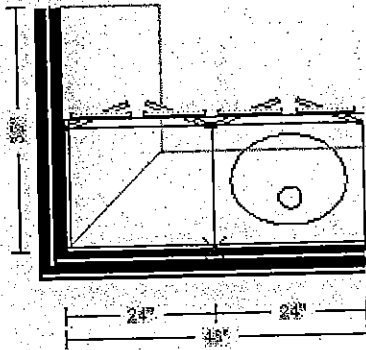

Housing Authority for County of Stanislaus
Pricing for Ceres Housing Upgrades – Building Type “D”

14 @ BUILDING TYPE “D”
7-BEDROOM DUPLEX APARTMENTS (28 Total Apartments)

CABINET TYPE	NUMBER OF CABINETS
Euro Kitchen (13.5 feet)	5 Base, 4 Upper
Euro Vanity BV48	2 Base
Euro Laundry W8424	2 Upper

3

RANGE AND COUNTERTOP SHOWN FOR ILLUSTRATION PURPOSES ONLY.

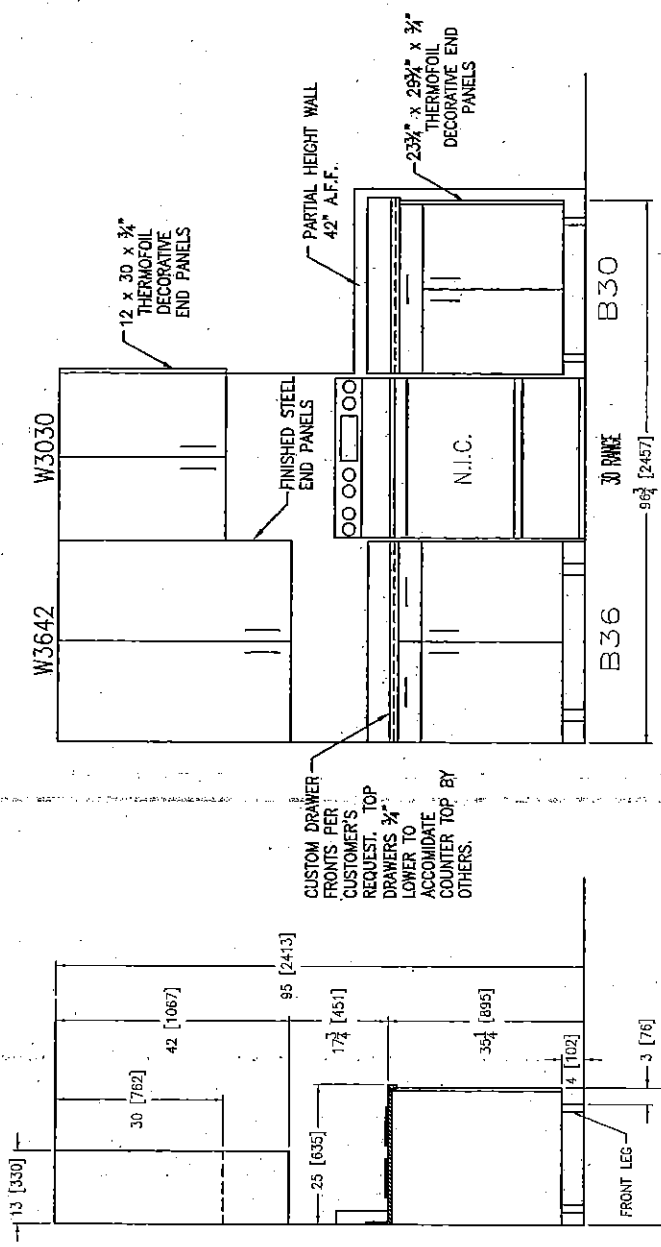

ELEVATION

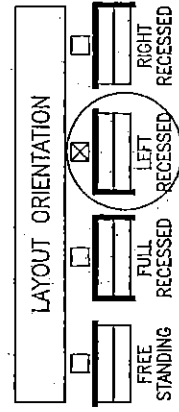

APPROVED SIGNATURE: X

Accessories: KC-22646-D1

D- 07/14

CERES FARM LABOR 3 BEDROOM UNIT

MODEL: D-14 units

Cabinets	
Cab box material	STEEL
Cab box color	TBD
Door material	THERMOFOIL
Door color	TBD
Door style	TBD
Countertop/Sink/Faucet	
Countertop material	N.I.C.
Color name/number	-
Sink type	-
Sink dimension	-
Faucet type	-
Faucet finish	-
Appliances	
Refrig type/color	N.I.C.
Range type/size	N.I.C.
Range color	N/A
Cooktop	N/A
Dishwasher size/color	N/A
Microwave type	N/A
Microwave size	N/A
Microwave color	N/A

Notes

1. For recessed units additional refrigerator space is needed. For door to open properly, allow 25-1/2" space total.
2. Kitchen cabinetry and appliances must be installed at finished floor height (for removability).
3. Refer to sheet 2 for roughing-in detail.
4. Specifications subject to change.
5. Linear dimensions are shown in inches and [millimeters].
6. Drawing is not drawn to scale.

DRAWN: PH DATE: 10/01/09 REP.: 249

No. of Units: 1

REVISID: Backwall Shield material/Color N/A

REVISID: Endwall Shield material/Color N/A

REVISID: Disposal N/A

REVISID: Under Cabinet Light N/A

REVISID: Range Hood Size/Color N/A

FAUCET AND COUNTERTOPS SHOWN FOR ILLUSTRATION PURPOSES ONLY.

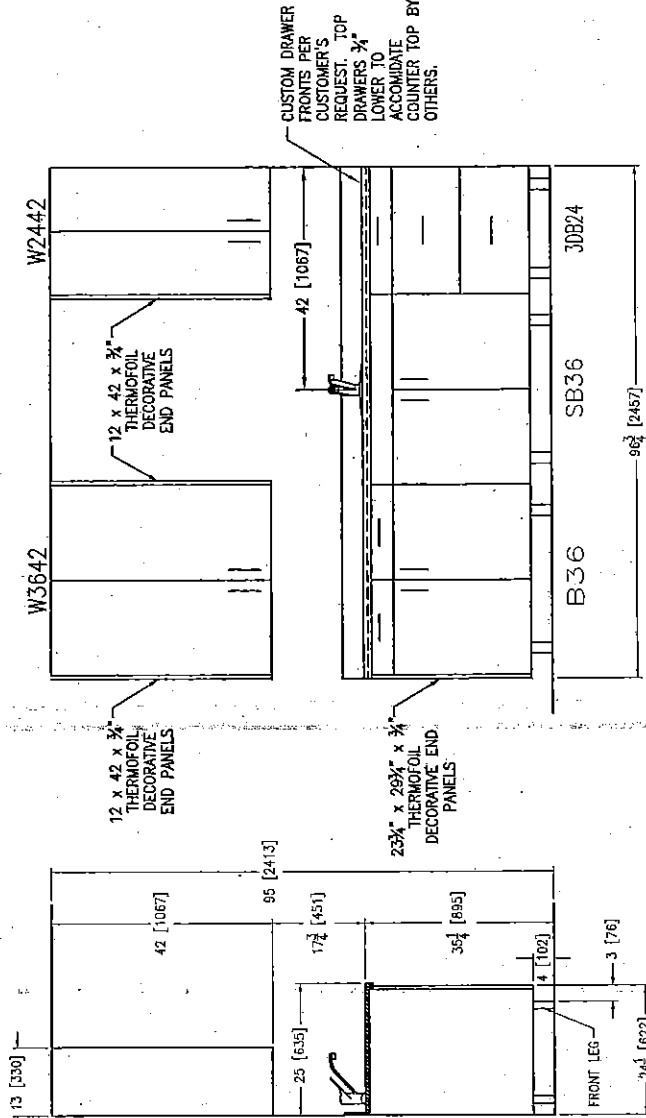

SIDE VIEW

ELEVATION

LAYOUT ORIENTATION

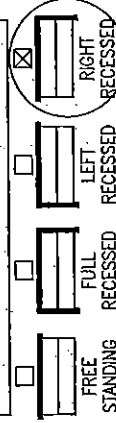

APPROVED SIGNATURE:

X

14 Units

Accessories:

KC-22646-D2

CUSTOM KITCHEN DESIGNED FOR:
CERES FARM LABOR
3 BEDROOM UNIT

MODEL: D 14 Units

Cabinets	
Cab box material	STEEL
Cab box color	TBD
Door material	THERMOFOIL
Door color	TBD
Door style	TBD
Countertop/Sink/Faucet	
Countertop material	N.I.C.
Color name/number	-
Sink type	-
Sink dimension	-
Faucet type	-
Faucet finish	-
Appliances	
Refrig type/color	N.I.C.
Range type/size	N.I.C.
Range color	N/A
Cooktop	N/A
Dishwasher size/color	N/A
Microwave type	N/A
Microwave size	N/A
Microwave color	N/A

Notes

- For recessed units additional refrigerator space is needed. For door to open properly, allow 25-1/2" space total.
- Kitchen cabinetry and appliances must be installed at finished floor height (for removability).
- Refer to sheet 2 for roughing-in detail.
- Specifications subject to change.
- Linear dimensions are shown in inches and [millimeters].
- Drawing is not drawn to scale.

DRAWN: PH DATE: 10/01/09 REP.: 249

No. of Units: 1

REVISED:

REVISED:

Backwall Shield Material/Color	N/A
Endwall Shield material/Color	N/A
Disposal:	N/A
Under Cabinet Light:	N/A
Range Hood Size/Color	N/A

Cabinets	
Cab box material	STEEL
Cab box color	TBD
Door material	THERMOFOIL
Door color	TBD
Door style	TBD
Countertop/Sink/Faucet	
Countertop material	N.I.C.
Color name/number	-
Sink type	N/A
Sink dimension	-
Faucet type	N.I.C.
Faucet finish	-
Appliances	
Refrig type/color	N.I.C.
Range type/size	N.I.C.
Range color	-
Cooktop	N/A
Dishwasher size/color	N/A
Microwave type	N/A
Microwave size	N/A
Microwave color	N/A

Notes

- For recessed units additional refrigerator space is needed. For door to open properly, allow 25-1/2" space total.
- Kitchen cabinetry and appliances must be installed at finished floor height (for removability).
- Refer to sheet 2 for roughing-in detail.
- Specifications subject to change.
- Linear dimensions are shown in inches and [millimeters].
- Drawing is not drawn to scale.

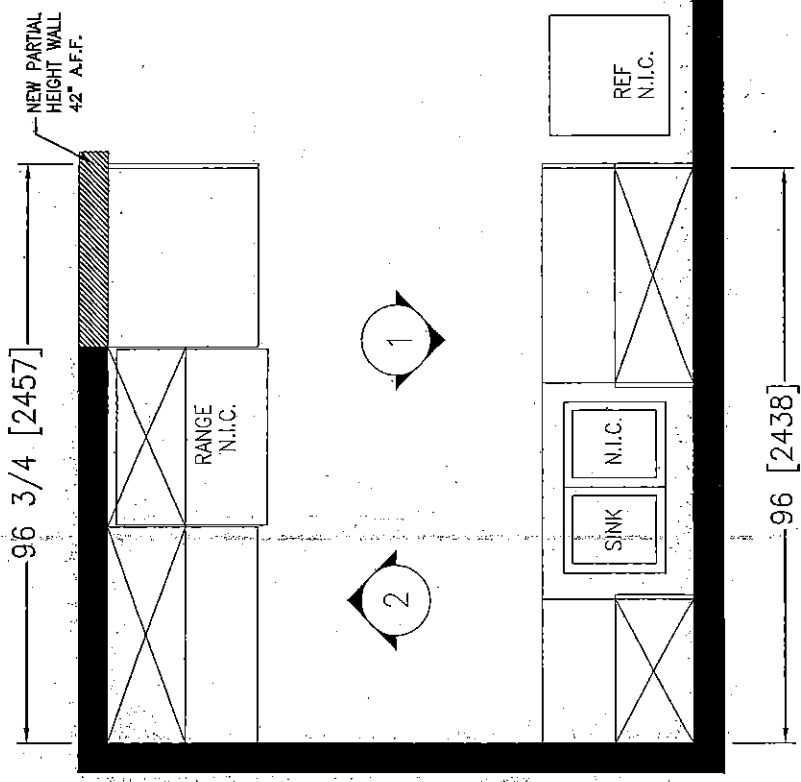

PLAN VIEW

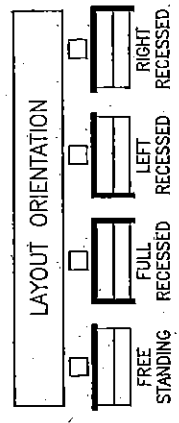

APPROVED SIGNATURE: _____

X

© COPYRIGHT

DRAWN: PH	DATE: 10/01/09	REP.: 249	Accessories:	KC- 22646-D
No. of Units:	1		Backwall Shield Material/Color	N/A
REVISED:			Endwall Shield material/Color	N/A
REVISED:			Disposal:	N/A
			Under Cabinet Light:	N/A
			Range Hood Size/Color:	N/A

CUSTOM KITCHEN DESIGNED FOR:

CERES FARM WORKERS
3 BEDROOM UNIT

MODEL: D-14Hents